



GUNTHERMELE 1857
PACKAGE WITH PURPOSE



OUR VISION

“Helping our customers tell their unique brand story while providing a customer experience like no other.”

– Darrell King, President

Welcome to our new packaging guide – our 165th version since our founding in 1857. We have some exciting developments in the following pages. Most of the changes we have ushered in this year are centered around a more sustainable approach to our business with an emphasis on the materials we use and the reusability of our products. We have begun to view all of our products through this new lens of eco-minded sustainability. We call this our “**Mission Green**”.

Mission Green drives us to use materials that are either from recycled or sustainable sources. It also focuses us on a vastly overlooked practice in sustainability: reusability.



RECYCLED

There are two important terms that classify the source of recycled content. These are: post-consumer waste and post-industrial waste. Post-consumer waste (PCW). Wherever possible, we are using paper and now plastics that are derived, at least partially if not fully, from municipal recycling programs and this term post-consumer implies that it has been recovered after consumer use. Post-industrial waste (PIW). Another key source of recycled material. In this instance, scrap material is diverted from the landfill and recycled into new material to be used in production. Product Examples include: our brand new, Canadian made paper twist shoppers made from paper that is derived from 96% post-consumer waste. Our new “resuede” is a luxurious recycled material that feels like plush suede but is produced using recycled materials to create a luxury look and feel. We feature our resuede material in our Drawer Series box (page 41) and our Eco Series of hinged boxes (page 33)

SUSTAINABLE



FSC® – Forestry Stewardship Council®. In short, this governing body oversees wood and pulp (paper) products derived from responsibly managed forests. This global governing body is an intricate certification process that verifies paper and its sources. In the instances where paper needs to come from new pulp source, we are choosing to use papers that carry the widely recognized FSC designation.

REUSABLE

Jewelry packaging has an inherent keepsake quality. Most people will collect jewelry boxes for storage and sentimental value. We have also been studying consumer behavior and there is demand for an after use of jewelry packaging. Our active lifestyles and thirst for travel dictates the need to store and protect jewelry when it is not being worn. With that, we have introduced our new Nano™ collection of luxurious and practical travel pouches that not only present the jewelry exquisitely but also doubles as ongoing storage and protection for our society who is always on the go.

In nearly every category we have exciting new products that meet our Mission Green criteria. These are just the first steps of our journey toward more sustainable and eco-conscious packaging solutions and we hope you’ll join us on this important journey.

SPECIAL ORDER

Jewelry Display



Tell your brand story
Create your unique identity
Elevate the shopping experience
Drive more sales
Complimentary Display Design
Financing Programs Available

*Complete set of renderings available with payment of deposit.
Deposits will be deducted from invoice at time of billing.



SPECIAL ORDER

Jewelry Display

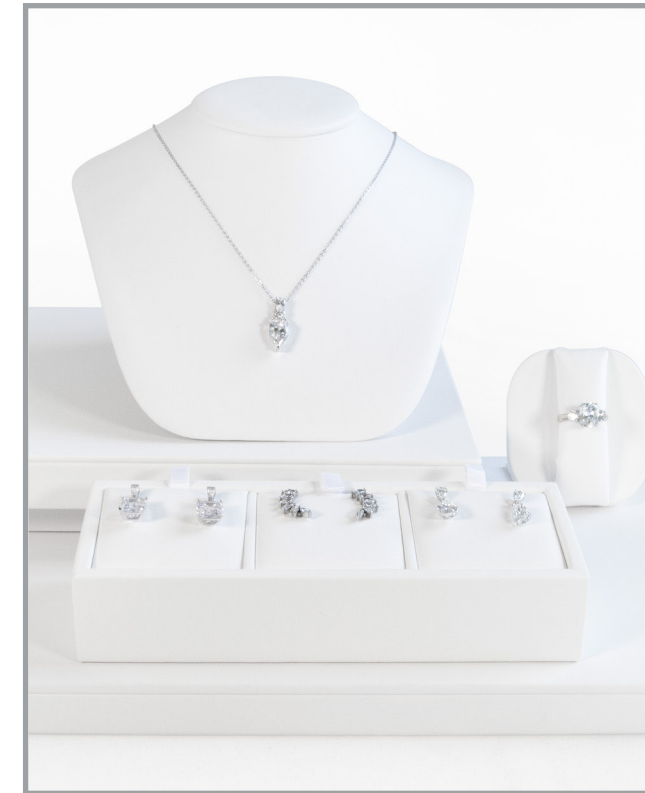

Platforms and Risers
Ring Showcase
Pendant & Earring Stands
Neck Forms & Bracelet Stands
Trays, Counter Pads,
Chain Ramps
Open Stock and Prepacks
Available
Create Your Own Look



TABLE OF CONTENTS



Jewellery Packaging

Hinged Packaging	10 - 33	Horizon Series	32
New Richmond Wood Series	11	EcoBox ECO	33
Monterey II	13	Create Your Own Look Details	34 - 35
Signature Series	15	Jewellery Folders	36 and 37
Whisper	17	Paperboard Jewellery Packaging.....	38 - 43
Eclipse Series ECO	19	New Tux Series ECO	39
Estate Series	20	Deco Series ECO	40
Roma Series ECO	21	ECO The Drawer Box, Vision Box	41
New Geo Series (new colour) ECO	23	Royale Series	42
Geo Special Order	25	New Mystique Series ECO	43
Palladium Inlay	26	Nest Boxes ECO	44 - 45
New Glitter Black	27	Gift Card and Certificate Boxes	46 - 47
Vantage II ECO	29	Pouches	48 - 49
New Jewellers Velvet (new colour)	39	Jewellery Cloths and Cleaners	50 - 51
New Alpha Series	31	Repair Envelopes and Tags	52

Bags

Vantage, Eclipse and Geo Eurototes	54	Paper Twist Handle & Damask ECO	63
Grosgrain Handle Eurototes	55	Merchandise Paper Bags ECO	64
New Eco-Lux Paper Eurototes ECO	56	Food Service Kraft Bags ECO	65
All Paper Eurototes ECO	57	New CYOL Jute and Cotton ECO	66 - 67
CYOL Rope Handle	58	New Ultrasonic Weld Reusable ECO	68
Manhattan Eurototes	59	New Smart Bag Reusable	69
5th Avenue Eurototes	60	Custom Full Colour Reusable	70
Special Order Tints and Pinstripe	60	In Stock Reusable Fabric Shoppers.....	71
New San Fran Natural Shoppers ECO	61	Garment Covers.....	94
CYOL Simply Paper Shoppers ECO	62		

Gift Boxes and E-Commerce

New Rigid Collapsible ECO	74	CYOL E-Com Boxes and Mailers.....	78
White Folding Gift Boxes	75	In Stock E-Com Boxes for Gift & Apparel....	79
Apparel Boxes	75	In Stock E-Com Boxes for Jewellery	79
Malibu Magnetic Gift Box	76	In Stock and S/O E-Com Mailers	80
Tuckit® Boxes ECO	76		

Finishing Touches

Inspirations Gift Wrap	82 - 83	Printed and Unprinted Ribbon	90 - 93
Special Order Gift wrap	84- 85	In Stock Seals - Foil Print	94 - 95
Special Order Jewellers Rolls	85	Custom Seals - Full Colour	96 - 97
Tissue Paper	86 - 87	Print Information & Print Colours....	98 - 99
Bows, Cellophane & Dispensers	88- 89		



JEWELRY PACKAGING



CREATE YOUR OWN LOOK



WOOD SERIES

The possibilities are endless when you choose wooden materials. Endless and timeless, in terms of size, shape, finish and color. High-end style, this collection features our Monterey series shape with a high gloss white finish, black “reveal” edge and black linea interior. Add a matching custom tote bag to complete the look.

IN STOCK

Hinged Boxes



Richmond

- Satin walnut
- Ivory brushed suedine pads and top liners
- Packaged in a black 2-piece outer box

CODE	DESCRIPTION	SIZE (inches)	PRICE /EACH	
			12+	144+
A 36521420	Ring (R1)	2.375 x 2.375 x 2	\$12.63	\$11.46
B 36522420	Earring (E1)	2.375 x 2.375 x 2	\$13.27	\$12.03
C 36583420	Utility T-pad (ET14)	4 x 4 x 2	\$22.11	\$20.05
D 36550420	Pillow (PL1)	4.375 x 4.375 x 2.75	\$28.63	\$25.97
E 36593420	Bracelet (BL1)	9.5 x 2.375 x 1.5	\$25.78	\$23.39
F 36573420	Necklace (N1)	7.5 x 7.5 x 2	\$40.52	\$36.80

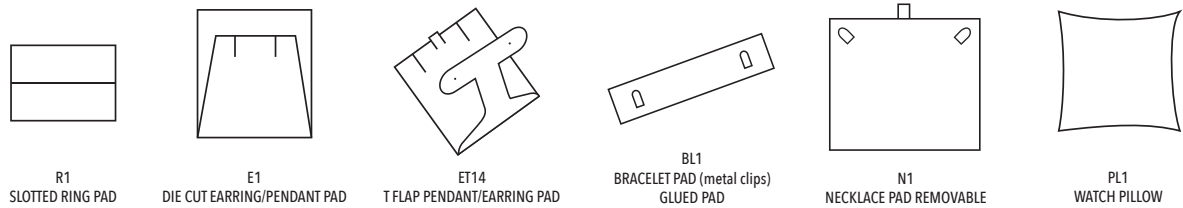

FOIL / PAD PRINT
F: inside liner and packer lid / PP: all 3 locations
12+ 42¢ each
144+ 38¢ each
504+ 31¢ each

Minimum 12 per style.
Please allow 2 - 3 weeks for printed items
from approved art.

All print orders subject to set-up charges. Applicable artwork, and plate charges may apply. See page 98.

CREATE YOUR OWN LOOK



WOOD SERIES

The possibilities are endless when you choose wooden materials. Endless and timeless, in terms of size, shape, finish and color. High-end style, this collection features our Monterey series shape with a high gloss white finish, black “reveal” edge and black linea interior. Add a matching custom tote bag to complete the look.

IN STOCK Hinged Boxes



**COORDINATING
EUROTOTES**
See pages 55



Available Colors

Outer Box
150MC - Black Gloss

Outer Box
320M - Mahogany

**150MCB - OPTIONAL
BLACK INTERIOR
RING BOX ONLY**

Monterey II

Wood series with modern lines and a gloss finish.

- Soft white leatherette interior
- Packaged in a 2-piece white traditional outer box

	CODE	DESCRIPTION	SIZE (inches)	PRICE/EACH	
				12+	144+
A	36821 _ _ _ _	Ring (R1)	2.375 x 2.375 x 2	\$12.64	\$10.95
B	36822 _ _ _ _	Earring (E1)	2.375 x 2.375 x 2	\$12.64	\$10.95
C	36843 _ _ _ _	Utility T-pad (ET14)	4 x 4 x 2	\$23.06	\$19.50
D	36850 _ _ _ _	Pillow (PL1)	4.375 x 4.375 x 2.75	\$25.91	\$23.23
E	36893 _ _ _ _	Bracelet (BL1R)	9.5 x 2.375 x 1.5	\$25.31	\$22.72
F	36813 _ _ _ _	Necklace (N1)	7.5 x 7.5 x 2	\$42.93	\$38.52

SCAN THIS CODE ON
YOUR PHONE TO ORDER

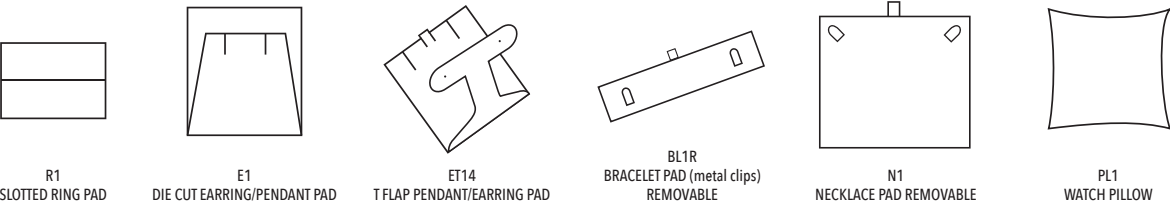

FOIL / PAD PRINT
F: inside liner and packer lid / PP: all 3 locations
12+ 42¢ each
144+ 38¢ each
504+ 31¢ each

Minimum 12 per style.
Please allow 2 - 3 weeks for printed items from approved art.

All print orders subject to set-up charges. Applicable artwork, and plate charges may apply. See page 98.

CREATE
YOUR OWN LOOK

IN STOCK
Hinged Boxes

JEWELRY PACKAGING

JEWELRY PACKAGING



Signature Series

Experience exceptional luxury at an even more accessible price.

- Plush black velvet hinged boxes accented with suede pads and bengaline trim detail
- Packaged in a coordinating 2-piece outer box

CODE	DESCRIPTION	SIZE (inches)	PRICE/EACH	
			12+	144+
A 36521151	Ring (R1)	1.96 x 1.96 x 1.96	\$5.58	\$4.91
B 36522151	Pendant/Earring (E1)	2.36 x 2.36 x 2.28	\$6.95	\$6.13
C 36583151	Utility (empty)	3.93 x 3.93 x 2.36	\$7.61	\$6.70
C1 69550151	Pillow (PL1)	fits utility box	\$1.72	\$1.51
C2 69583151	Triple Flip Pad (T3)	fits utility box	\$1.72	\$1.51
D 36573151	Necklace (N3)	7 x 7 x 1.77	\$12.30	\$10.82



SCAN THIS CODE ON
YOUR PHONE TO ORDER



FOIL / PAD PRINT
F / PP: inside liner and packer lid
12+ 42¢ each
144+ 38¢ each
504+ 31¢ each

Minimum 12 per style.
Please allow 2 - 3 weeks for printed items from approved art.

All print orders subject to set-up charges. Applicable artwork, and plate charges may apply. See page 98.

VELVET SERIES

Plush velvet hinged boxes accented with suede pads and bengaline trim detail.



See page 34.

CREATE YOUR OWN LOOK



WHISPER SERIES

Our modern luxury box is shown here in a stylish textured gold paper called: Shuttle. Matching texture, the interior and pads create a seamless look.

IN STOCK Hinged Boxes



**COORDINATING
EUROTOTE**
See page 59

Available Colors



559W - Carbon Black



009W - Moon Glow



289W - Palladium

Whisper

Elegant curves and round corners.

- Monochromatic metallic pinksketch linea fabric
- Packaged in a coordinating 2-piece outer box

CODE	DESCRIPTION	SIZE (inches)	PRICE/EACH	
			12+	144+
A 36821	Ring (R1)	2.375 x 2.375 x 2.125	\$7.94	\$6.89
B 36822	Earring (E1)	2.375 x 2.375 x 2.125	\$7.94	\$6.89
C 36823	Large Ring (R1)	3.25 x 3.25 x 2.25	\$11.58	\$10.08
D 36883	Utility T-pad (ET14)	3.25 x 3.25 x 2.25	\$10.71	\$9.26
E 36850	Pillow (PL1)	4 x 4 x 2.75	\$14.48	\$12.58
F 36893	Bracelet (BL1)	9.25 x 2.5 x 1.75	\$14.27	\$12.41
G 36873	Necklace (N3)	6.5 x 8 x 1.75	\$22.32	\$18.33

SCAN THIS CODE ON
YOUR PHONE TO ORDER

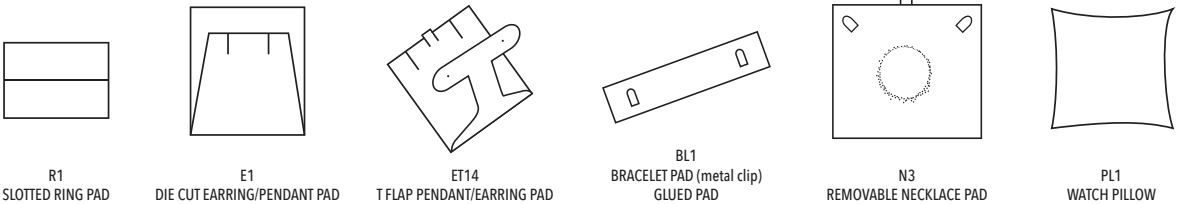

FOIL / PAD PRINT
F: inside liner and packer lid / PP: all 3 locations
12+ 42¢ each
144+ 38¢ each
504+ 31¢ each

Minimum 12 per style.
Please allow 2 - 3 weeks for printed items from approved art.

All print orders subject to set-up charges. Applicable artwork, and plate charges may apply. See page 98.

CREATE
YOUR OWN LOOK

IN STOCK
Hinged Boxes

JEWELRY PACKAGING



ECLIPSE SERIES

This eclipse collection features an elegant champagne custom embossed covering with an ivory shimmer interior and gold printed logo on the top liner. The custom rope handle tote completes this beautiful collection.

COORDINATING
EUROTOTE
See page 56

Available Colors

813 - Linea Blue Celestial

663 - Linea Aubergine

423 - Brown

Outer Box

Outer Box

Outer Box

50% Recycled Shell

Eclipse
Classic square corners with a distinctive crescent style front.

- Linea Aubergine and Linea Blue Celestial coverings with Ivory Shimmer satin top liners and pads. Packaged in coordinating full-depth 2-piece outer box
- Rich Brown leatherette covering with Champagne satin top liners and sueded pads. Packaged in white full-depth 2-piece outer box

CODE	DESCRIPTION	SIZE (inches)	AUBERGINE AND BLUE PRICE/EACH		BROWN PRICE/EACH	
			12+	144+	12+	144+
A 36821 _ _ _	Ring (R1)	2.5 x 2.5 x 1.75	\$10.33	\$9.30	\$7.37	\$6.67
B 36822 _ _ _	Earring/Pendant (E1)	2.5 x 2.5 x 1.75	\$10.33	\$9.30	\$7.37	\$6.67
C 36883 _ _ _	Utility T-pad (ET14)	3.75 x 4 x 1.75	\$17.82	\$16.06	\$12.92	\$11.61
D 36893 _ _ _	Bracelet (BL1R)	9.25 x 2.5 x 1.75	\$23.02	\$20.72	\$14.21	\$12.82
E 36873 _ _ _	Necklace (N2)	6.5 x 8 x 1.75	\$37.28	\$33.58	\$29.02	\$26.22
F 36850 _ _ _	Pillow (PL1)	3.75 x 4.25 x 3	\$24.84	\$22.34	\$16.54	\$14.91

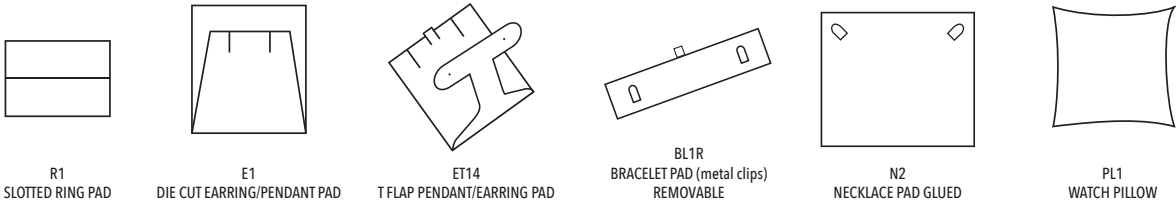

FOIL / PAD PRINT
F: inside liner and packer lid / PP: all 3 locations
12+ 42¢ each
144+ 38¢ each
504+ 31¢ each

Minimum 12 per style.
Please allow 2 - 3 weeks for printed items from approved art.

All print orders subject to set-up charges. Applicable artwork, and plate charges may apply. See page 98.

IN STOCK

Hinged Boxes



COORDINATING
EUROTOTE
See pages 56



Available Colors



New

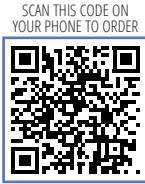

Estate

Contemporary style with a touch of tradition.

- White velvet pads and satin top liners
- Packaged in a coordinating 2-piece outer box

CODE	DESCRIPTION	SIZE (inches)	PRICE/EACH	
			12+	144+
A 36021 _ _ _	Ring (R1)	2 x 2.25 x 1.875	\$6.58	\$6.21
B 36022 _ _ _	Earring (E1)	2 x 2.125 x 1.625	\$6.58	\$6.21
C 36084 _ _ _	Utility T-pad (ET14)	3.5 x 3.5 x 1.5	\$7.83	\$7.11
D 36093 _ _ _	Bracelet (BL1R)	8.5 x 2.125 x 1	\$12.63	\$11.76
E 36073 _ _ _	Necklace (N2)	7.125 x 4.375 x 1.25	\$15.16	\$13.91



FOIL / PAD PRINT
F: inside liner and packer lid / PP: all 3 locations
12+ 42¢ each
144+ 38¢ each
504+ 31¢ each

Minimum 12 per style.
Please allow 2 - 3 weeks for printed items from approved art.



IN STOCK

Hinged Boxes



COORDINATING
EUROTOTE
See page 56



Roma

Distinctive round corner styling with sculpted sides.

- Lizard style embossed covering with leatherette interior
- Packaged in a 2-piece coordinating outer box with ¼ depth lids

CODE	DESCRIPTION	SIZE (inches)	PRICE/EACH	
			12+	144+
A 36421 _ _ _ _	Ring (R1)	2.25 x 2.25 x 1.75	\$7.33	\$6.62
B 36422 _ _ _ _	Earring (E1)	2.25 x 2.25 x 1.75	\$7.33	\$6.62
C 36484 _ _ _ _	Utility T-pad (ET14)	3.75 x 3.75 x 2	\$11.07	\$9.47
D 36493 _ _ _ _	Bracelet (BL1R)	9.375 x 2.25 x 1.5	\$12.57	\$11.30
E 36477 _ _ _ _	Necklace (N2)	7.5 x 7.5 x 2.125	\$26.31	\$23.67



FOIL / PAD PRINT
F: inside liner and packer lid / PP: all 3 locations
12+ 42¢ each
144+ 38¢ each
504+ 31¢ each

Minimum 12 per style.
Please allow 2 - 3 weeks for printed items from approved art.

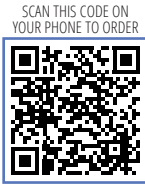

CREATE YOUR OWN LOOK



GEO SERIES

A series completely unique with added top stitching to the covering and upgrading the fabric to a luxurious grey leatherette. This Geo collection features a debossed logo on the top of the lid. Matching dark interior pads create a seamless look to showcase fine pieces. Packaged in two-tone 3/4 depth outer box with a silver embossed print. This collection is completed with coordinating custom rope handle totes.

IN STOCK

Hinged Boxes



E-Commerce Jewelry Boxes

Deliver the 'in-store' experience to your customer's door.
See page 79 for more information

COORDINATING EUROTOTE
See page 54



Available Colors



873B - Bronze



563P - Purple



153B - Black



083P - Platinum*

New

SCAN THIS CODE ON YOUR PHONE TO ORDER



Geo

Modern texture in a choice of 4 color options.

- Ivory brushed leatherette pads and satin top liners
- Packaged in a coordinating ¾ depth 2-piece outer box

CODE	DESCRIPTION	SIZE (inches)	PRICE/EACH	
			12+	144+
A 36221	Ring/Earring (R1)	2.375 x 2.375 x 2.375	\$6.20	\$5.55
B 36283	T-pad Pendant (ET14)	3.5 x 4.5 x 1.5	\$8.19	\$7.05
C 36293	Bracelet (BL1R)	9 x 2.375 x 1.5	\$10.83	\$9.73
D 36273	Necklace (N3)	7 x 7 x 1.5	\$18.41	\$16.58
E 36220	Proposal Box* (R2)	2.36 x 2.36 x .94	\$5.12	\$4.45
F 36224	Lighted Ring/Earring* (R1)	2.36 x 2.36 x 2.36	\$17.02	\$15.75
G 090304	Pouch with Box*	3 x 4	\$3.09	\$2.59
69221100G	Earring Pad to fit Ring/Earring box (E8)		\$1.07	

* not available in Platinum

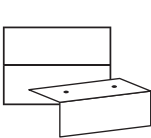

2-PIECE EARRING / R1 SLOTTED RING PAD

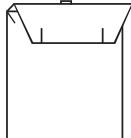

E8 LEVER BACK EARRING PAD



ET14 T FLAP PENDANT/EARRING PAD

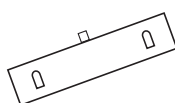

BL1R BRACELET PAD (metal clips) REMOVABLE

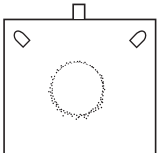

N3 REMOVABLE NECKLACE PAD



R2 EUROPEAN STYLE CLIP PAD



FOIL / PAD PRINT

F: inside liner and packer lid / PP: all 3 locations

12+ 42¢ each
144+ 38¢ each
504+ 31¢ each

Minimum 12 per style.

Please allow 2 - 3 weeks for printed items from approved art.

All print orders subject to set-up charges. Applicable artwork, and plate charges may apply. See page 98.

IN STOCK

Hinged Boxes



Palladium Inlay

Stylish contemporary series.

- Palladium grey brushed exterior
- Cream pads and top liner with matching exterior edge
- Packaged in a coordinating 2-piece outer box

CODE	DESCRIPTION	SIZE (inches)	PRICE/EACH	
			12+	144+
A 36221283P	Ring (R1)	2.25 x 2 x 1.75	\$8.23	\$6.76
B 36222283P	Earring (E1)	2.25 x 2 x 1.75	\$8.23	\$6.76
C 36283283P	Utility T-pad (ET14)	3.18 x 4.17 x 1.41	\$11.61	\$9.86
D 36293283P	Bracelet (BL1)	8.6 x 2.16 x 1	\$13.35	\$11.18
E 36273283P	Necklace (N1)	6.25 x 4.4 x 1.41	\$15.95	\$13.43



FOIL / PAD PRINT
F: inside liner and packer lid / PP: all 3 locations
12+ 42¢ each
144+ 38¢ each
504+ 31¢ each

Minimum 12 per style.
Please allow 2 - 3 weeks for printed items from approved art.



IN STOCK

Hinged Boxes



Glitter Black

Sparkle and shine with this great glittering series.

- Black faux suede pads and satin top liners
- Packaged in individual black sleeves

CODE	DESCRIPTION	SIZE (inches)	PRICE/EACH	
			12+	144+
A 36221183GB	Ring (R1)	1.75 x 2 x 1.5	\$3.24	\$2.79
B 36222183GB	Earring (E1)	1.75 x 2 x 1.5	\$3.24	\$2.79
C 36284183GB	Utility T-pad (ET14)	3.5 x 3.5 x 1.25	\$5.42	\$4.77
D 36293183GB	Bracelet (BL1)	8.75 x 2.125 x 1	\$6.99	\$6.15
E 36273183GB	Necklace (N1)	6.25 x 4.25 x 1.25	\$8.89	\$7.82



FOIL / PAD PRINT
F: inside liner / PP: inside top liner and box lid
12+ 42¢ each
144+ 38¢ each
504+ 31¢ each

Minimum 12 per style.
Please allow 2 - 3 weeks for printed items from approved art.

CREATE YOUR OWN LOOK



VANTAGE SERIES

6 pieces – 2 boxes + 4 inserts + 9 presentations. A streamlined and customized assortment.



**COORDINATING
EUROTOTE**
See below and on page 54



Vantage II

Elegant gold or silver in a linen embossed pattern.

- White satin top liners and leatherette bottom pads
- Packaged in a coordinating 3/4 depth lid 2-piece outer box

CODE	DESCRIPTION	SIZE (inches)	PRICE/EACH	
			12+	144+
A 36221 _ _ _	Ring/Earring (R1/E8)	2 x 2 x 1.625	\$6.35	\$5.39
B 36232 _ _ _	T-Pad Pendant (ET14)	2.64 x 2.72 x 2.165	\$7.62	\$6.50
C 36284 _ _ _	Utility T-pad (ET14)	3.5 x 3.5 x 2	\$9.26	\$7.87
D 36293 _ _ _	Bracelet (BL1)*	8.625 x 2.125 x 1.25	\$12.62	\$10.49
E 36273 _ _ _	Necklace (N1)	6.25 x 4.5 x 1.5	\$15.86	\$13.32

* Bracelet is sold out and no longer available in 307-Gold

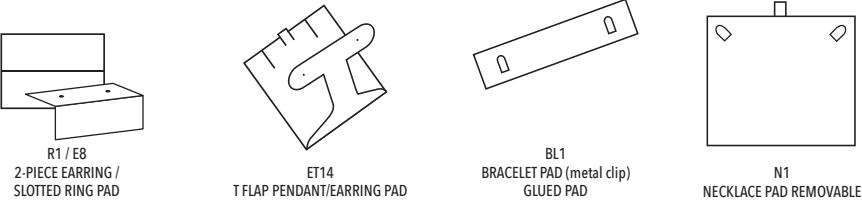

FOIL / PAD PRINT
F: inside liner and packer lid / PP: all 3 locations
12+ 42¢ each
144+ 38¢ each
504+ 31¢ each

Minimum 12 per style.
Please allow 2 - 3 weeks for printed items from approved art.



Coordinating Eurototes

- 150 gsm uncoated paper with 8mm paper cord handles
- Minimum 100 per color

CODE	SIZE (inches)	PRICE/EACH		
		100+	500+	1000+
230606 _ _ _	6 x 3.5 x 6 x 3.5*	\$1.48	\$1.36	\$1.17
231008 _ _ _	10.5 x 5 x 8.5 x 5	\$1.88	\$1.68	\$1.45

* 6 x 3.5 x 6 x 3.5 is sold out and no longer available in 07V-Gold

FOIL PRINT
100+ 42¢ each
1000+ 38¢ each
2500+ 31¢ each

Estimated lead time: 2 - 3 weeks for printed items from approved art.



IN STOCK Hinged Boxes

IN STOCK

Hinged Boxes

COORDINATING EUROTOTE
See page 56



Available Colors

New 113 - Sapphire

151 - Black

671 - Green

Jewelers Velvet

Lasting traditions.

- Satin top liners
- Packaged in a white 2-piece outer box

CODE	DESCRIPTION	SIZE (inches)	12+	144+
A 36121 _ _ _	Ring (R1)	1.875 x 2.125 x 1.375	\$3.58	\$3.27
B 36141 _ _ _	Double Ring (R1)	2.625 x 2 x 1.5	\$4.58	\$4.12
C 36122 _ _ _	Earring (E2)	1.875 x 2.125 x 1.375	\$3.58	\$3.27
D 36132 _ _ _	Utility T-pad (ET14)	2.5 x 2.5 x 1.375	\$4.58	\$4.12
E 36163 _ _ _	Pendant (E1)	2.25 x 3 x 1.125	\$4.58	\$4.12
F 36183 _ _ _	Utility (EP4)	3.875 x 3.25 x 1.375	\$7.26	\$6.51
G 36193 _ _ _	Bracelet (BL1)	8 x 2 x 1.25	\$7.49	\$6.76
H 36173 _ _ _	Necklace (N1)	7 x 4.25 x 1.5	\$12.54	\$11.32

SCAN THIS CODE ON
YOUR PHONE TO ORDER

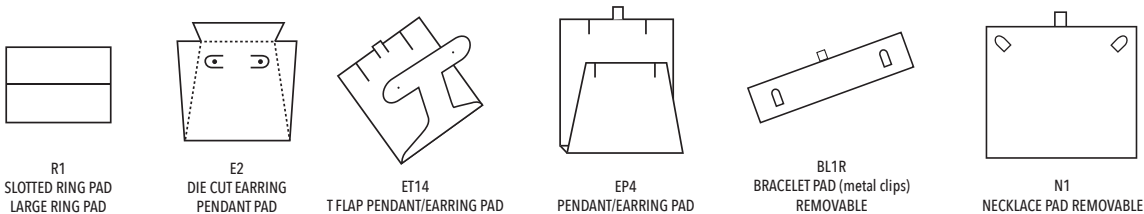

FOIL / PAD PRINT

F: inside liner and packer lid / PP: inside top liner and packer lid
12+ 42¢ each
144+ 38¢ each
504+ 31¢ each

Minimum 12 per style.
Please allow 2 - 3 weeks for printed items
from approved art.



FOIL / PAD PRINT

F: inside liner and packer lid / PP: inside top liner and packer lid
12+ 42¢ each
144+ 38¢ each
504+ 31¢ each

Minimum 12 per style.
Please allow 2 - 3 weeks for printed items
from approved art.

IN STOCK

Hinged Box

COORDINATING EUROTOTE
See page 54



New

Alpha

Style meets value.

- Soft white leatherette and top liners
- Packaged in a white 2-piece outer box

CODE	DESCRIPTION	SIZE (inches)	PRICE /EACH	
			12+	144+
A 36621002	Ring (R1)	1.875 x 2.125 x 1.375	\$3.64	\$3.29
B 36641002	Double Ring (R1)	2.375 x 2 x 1.375	\$3.85	\$3.46
C 36622002	Earring (E2)	1.875 x 2.125 x 1.375	\$3.32	\$2.99
D 36663002	Pendant (EP4)	2.25 x 3 x 1.125	\$4.94	\$4.45
E 36632002	T-pad Pendant (ET14)	2.5 x 2.5 x 1.375	\$4.32	\$3.89
F 36683002	Utility (EP4)	3.875 x 3.25 x 1.375	\$6.69	\$6.03
G 36693002	Bracelet (BL1)	8 x 2 x 1.125	\$6.87	\$6.18
H 36673002	Necklace (N1)	7 x 4.25 x 1.375	\$10.56	\$9.51

SCAN THIS CODE ON
YOUR PHONE TO ORDER

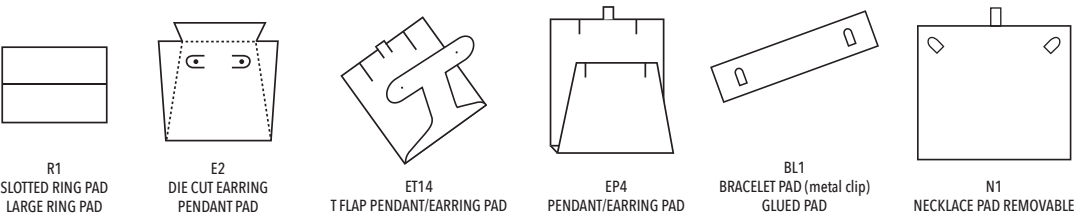

IN STOCK

Hinged Boxes



**COORDINATING
EUROTOTE**
See page 56

**E-Commerce
Jewelry Boxes**
Deliver the 'in-store' experience
to your customer's door.
**See page 79 for
more information**



Available Colors



Outer Box

003 - White

Outer Box

663 - Burgundy

Outer Box

153 - Black



Bead Pad

- pad fits stud earring box
- ribbon threads through bead
- ribbon wraps to back and is held by clip

Horizon

The gold standard in a classic white, burgundy and black.

- White velour pads and satin top liners
- Packaged in a white traditional 2-piece outer box

CODE	DESCRIPTION	SIZE (inches)	12+	144+
A 36621 _ _ _	Ring (R1)	2.125 x 2 x 2	\$3.86	\$3.46
B 36622 _ _ _	Earring (E1)	2.125 x 2 x 2	\$3.86	\$3.46
C 36641 _ _ _	Double Ring (R1)	3 x 2 x 2	\$4.56	\$4.10
D 36684 _ _ _	Utility T-pad (ET14)	3.5 x 3.5 x 1.5	\$6.15	\$5.02
E 36632 _ _ _	T-Pad Pendant (ET14)	2.75 x 2.75 x 1.375	\$5.28	\$4.74
F 36693 _ _ _	Bracelet (BL1)	8.25 x 2.125 x 1.25	\$8.42	\$7.59
G 36673 _ _ _	Necklace (N1)	6.25 x 5 x 1.5	\$13.68	\$12.31
H 36650 _ _ _	Bangle (R1)	1 x 3.75 x 3.125	\$6.59	\$5.95
I 69621000B	Bead Pad for earring box		\$0.86	\$0.71

BLACK PADS AVAILABLE (3 SIZES)

J 36621153B	Single Ring Pad (black)	2.125 X 2	box w/pad	\$3.86	\$3.46
69622153B	Stud Earring Pad (black)	2.125 x 2	pad only	\$0.30	\$0.27
69633153B	Pend/Earring Pad (black)	2.75 x 2.75	pad only	\$0.98	\$0.90



FOIL / PAD PRINT
F: inside liner and packer lid / PP: all 3 locations
12+ 42¢ each
144+ 38¢ each
504+ 31¢ each

Minimum 12 per style.
Please allow 2 - 3 weeks for printed items from approved art.



IN STOCK

Hinged Box



**COORDINATING
ALL PAPER EUROTOTE**
See page 57



Outer Sleeve

Ring box shown with optional earring pad in place

EcoBox

Modern look inside and out.

- Gunther Mele Mission Green product
- Made with recycled paper exterior
- Made with 50% recycled material plastic shell
- Resuede interior material (49% recycled)



CODE	DESCRIPTION	SIZE (inches)	PRICE/EACH 12+ 144+
A 36121000	Ring/Earring (R1/E8)	2 x 2 x 1.5	\$5.84 \$4.97
B 36163000	T-Pad Pendant/Earring (ET14)	3.75 x 3.75 x 1.33	\$9.39 \$7.99
C 36193000	Bracelet (BL1)	8.5 x 2 x .91	\$8.27 \$7.03
D 36173000	Necklace (N3)	7 x 5 x 1.10	\$15.01 \$12.77

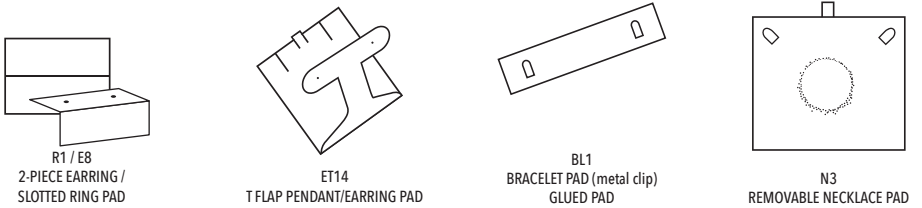

FOIL / PAD PRINT
F: inside liner / PP: top lid
12+ 42¢ each
144+ 38¢ each
504+ 31¢ each

Minimum 12 per style.
Please allow 2 - 3 weeks for printed items from approved art.

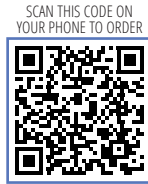

CREATE YOUR OWN LOOK

TELL YOUR BRAND STORY CREATE YOUR UNIQUE IDENTITY



Create Your Own Look in 7 Easy Steps

Speak to your
sales representative
for a consultation.

Looking for 100% custom design? Design your very own jewelry packaging.

STEP 1:

Choose your box style.
We have access to endless design and looks. You dream it,
we can create it.
Choose from wood, plastic, MDF and paperboard shells.
Select hinged or 2-piece.
MOQ:
Plastic or Metal 2,500
Wood 1,000
Paperboard 5,000

STEP 2:

Choose your covering and color.
Leatherette, velvet, paper.
Design your texture—hundreds to choose from, or create your
own. Brushed leatherette, embossed papers, smooth, textured,
Select from our color books, or use Pantone to specify your
exact colors.

STEP 3:

Specify the interior.
Select pad color and material for inside lid.
Leatherette, brushed leatherette, flocked, velvet, velour.
Decide on the top interior material—leatherette, brushed
leatherette, satin, flocked, velvet.
Select color—white, black, ivory are most common.
Option—create a reveal with contrasting color.

STEP 4:

Design your packer.
2- piece box or sleeve.
Often you can use the same material or create a
coordinating color.
Option -- add die cuts at bottom for ribbon, and/or reveal
for contrasting color.

STEP 5:

Design logo placement.
Areas to consider:
Inside box lid (Top Satin)
Packer Lid (can be centered, or placed at lower corner if using ribbon)
Top Lid



STEP 6:

Select your pad designs. (See page 35)

STEP 7:

Email your artwork.
Artwork ultimately needs to be in Vector file format. Your
graphic designers should be able to assist you. Gunther Mele
is also available to provide artwork assistance and full
service design, cost is \$85/hour, min half hour charge.

CYOL has 16-20 weeks lead time. (Time frames based on signed
approved artwork, quote and deposit).
Printing and pre-production samples included at no
extra charge.

Please note:

Logos with intricate lines and details (such as diamonds),
often will not translate in small print areas, such as top satins.
Designs with text and simple outlines work best for inside of
ring boxes, etc. Reps and our designers will advise you when
artwork should be modified to produce best results.

To ensure accuracy and best quality, signatures are required
on all artwork documents and quote documents where noted.
Production will not commence until all artwork, quotes and
deposits are finalized and signed off. Your rep is available to
work with you to ensure all documentation is completed to
prevent delays. Please ensure your email access is update date.

Complete your look!

Bags, Tissue, Pouches, Ribbon, Displays, Necklace folders, and more!
Select from our in stock or create your own. Gunther Mele is your one stop for all your needs.

Our sales representative can help you design all your packaging and displays to tell your unique brand story.

CREATE YOUR OWN LOOK

RING PADS

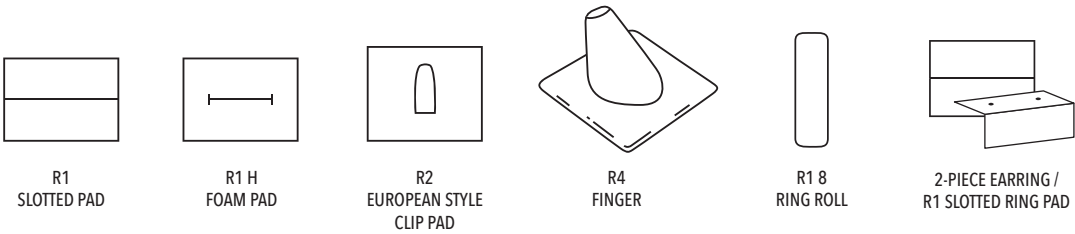

EARRING PADS

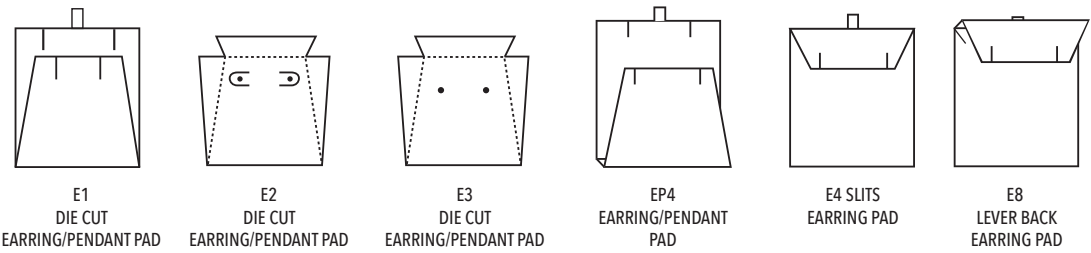

EARRING/ PENDANT PADS

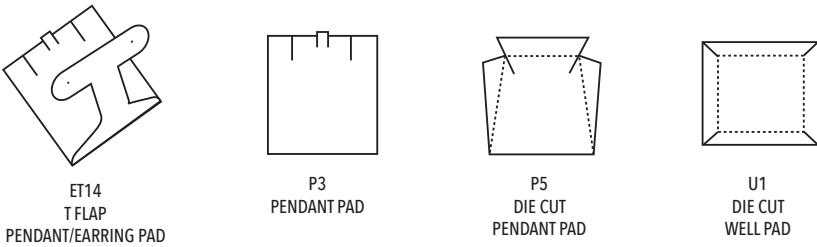

BRACELET AND WATCH PADS

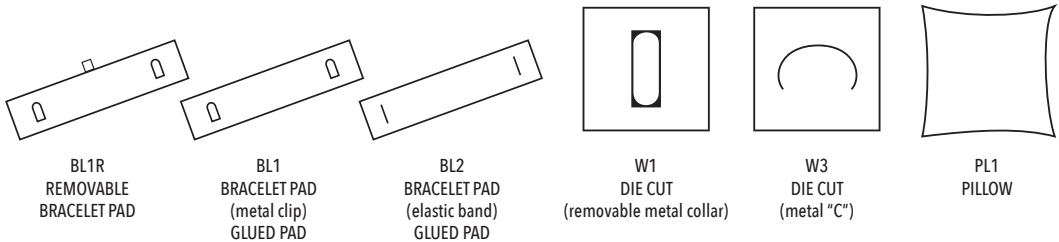

NECKLACE PADS

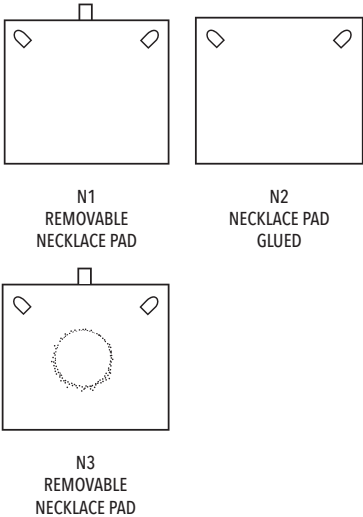

TRIPLE FLIP PADS

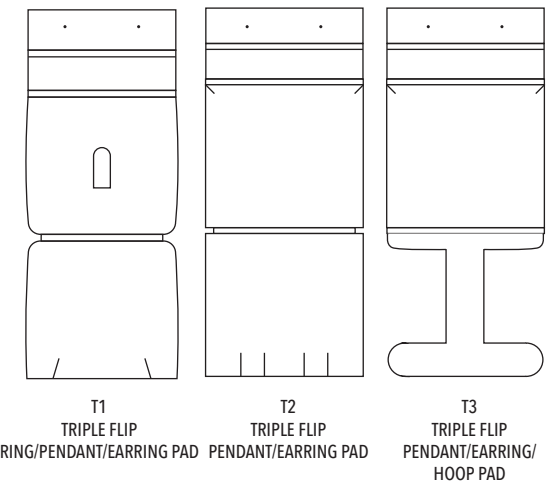

IN STOCK

Jewelry Packaging



Nano Clutch

Perfect for gifting and on the go, this collection is going places!

- Linea envelope, and pad
- Packaged in a 2-piece matching outer box

CODE	DESCRIPTION	SIZE (inches)	PRICE/EACH	
			12+	144+
09121 _ _ _ _	Ring (R1)	2.55 X 2.55	\$2.74	\$2.53
09163 _ _ _ _	Pendant (P3)	4 X 4	\$3.35	\$3.15
09193 _ _ _ _	Bracelet (BL1R)	9.625 X 3.125	\$4.09	\$3.76
09173 _ _ _ _	Necklace (N1)	6.625 X 6.625	\$5.89	\$5.59

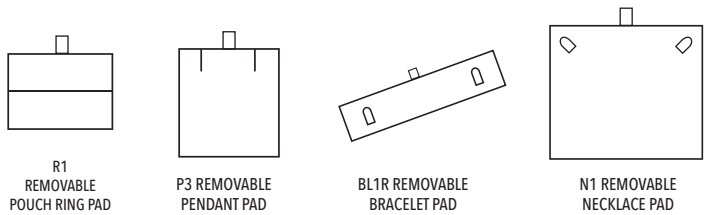

FOIL / PAD PRINT

F: outside flap and packer / PP: outside flap and packer
12+ 42¢ each
144+ 38¢ each
504+ 31¢ each

Minimum 12 per style.
Please allow 2 - 3 weeks for printed items from approved art.



Available Colors



151C - Carbon Black

001M - Diamond White

SCAN THIS CODE ON YOUR PHONE TO ORDER



15PB - Black

00PW - White



Passport Jewelry Folders

Designed with stylish envelope closure, snaps tight to keep jewels secure.

- Linea exteriors, satin interior
- Packaged in a 2-Piece white outer box
- Two colors soft white and black
- Case pack of 12

SCAN THIS CODE ON YOUR PHONE TO ORDER



CODE	DESCRIPTION	SIZE (inches)	12+	144+
367950 _ _ _ _	Bracelet	8.25 x 1.75	\$6.37	\$5.76
367900 _ _ _ _	Necklace/Pearl	6 x 8	\$10.12	\$9.13



FOIL / PAD PRINT

Bracelet: F and PP: inside bottom flap and packer lid
Necklace: PP: top flap / F and PP: inside flap and packer lid
12+ 42¢ each
144+ 38¢ each
504+ 31¢ each

Estimated lead time:
2 - 3 weeks for
printed items from
approved art.

Global Jewelry Folders

Wide gusset folder for larger pieces.

- Bronze and pearl linea
- Black faux suede
- Satin interior and magnetic closure
- Packaged in a 2-Piece matching outer box
- Case pack of 12

159W - Black
NO OUTSIDE PRINT

879B - Bronze



009P - Pearl

CODE	SIZE (in.)	PRICE / EACH	
		12+	144+
36790 _ _ _ _	5.5 x 7.5	\$14.21	\$12.49



FOIL / PAD PRINT

PP: top flap / F and PP: inside flap and packer lid
12+ 42¢ each
144+ 38¢ each
504+ 31¢ each

Estimated lead time: 2 - 3 weeks for
printed items from approved art.

SCAN THIS CODE ON YOUR PHONE TO ORDER



Hoop Earring Folder

Black ultrasuede folder with top stitch finish and black interior.
Holds hoop earrings up to 2.75" in diameter.

- Packaged in a white 2-Piece outer box
- Case pack of 12



Folder can only be
Deboss printed or
Clear Gloss or Gloss
Black printed.



FOIL / PAD PRINT

F: packer lid / PP: packer lid
12+ 42¢ each
144+ 38¢ each
504+ 31¢ each



DEBOSS PRINT

Below flap
12+ 38¢ each
144+ 35¢ each
504+ 29¢ each

SCAN THIS CODE ON YOUR PHONE TO ORDER



Estimated lead
time: 2 - 3 weeks
for printed items
from approved art.

All print orders subject to set-up charges. Applicable artwork, and plate charges may apply. See page 98.

All print orders subject to set-up charges. Applicable artwork, and plate charges may apply. See page 98.

CREATE
YOUR OWN LOOK

IN STOCK
2-Piece Boxes

JEWELRY PACKAGING

JEWELRY PACKAGING



Tux

A timeless classic.

- Black 2-piece boxes with white flocked foam pads
- Crisp white grosgrain ribbon
- Packaged in individual white sleeves

CODE	DESCRIPTION	SIZE (inches)	CASE PACK	PRICE/EACH	
				25+	500+
A 31521153	Ring (R1)	2.5 x 2.25 x 2	50	\$2.94	\$2.58
B 31583153	Utility (EP4)	3 x 3 x 2	50	\$3.51	\$3.10
C 31593153	Bracelet (BLR1)	9 x 2.25 x 1.5	50	\$4.59	\$4.05
D 31573153	Necklace (N1)	6.25 x 8 x 2	25	\$6.46	\$5.68

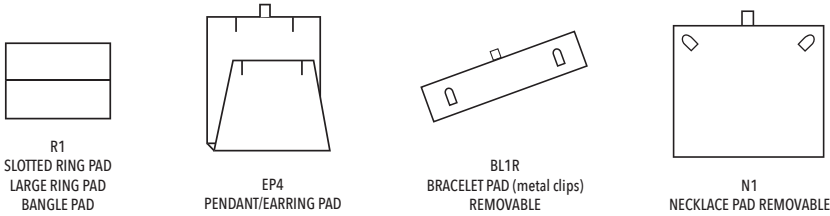

FOIL / PAD PRINT
F: inside and top lid / PP: inside and top lid
50/100+ 42¢ each
1000+ 38¢ each
2500+ 31¢ each

Minimum one case pack.
Please allow 2 - 3 weeks for printed items from approved art.

All print orders subject to set-up charges. Applicable artwork, and plate charges may apply. See page 98.

IN STOCK

Paperboard Hinged



**COORDINATING
EUROTOTE**
See page 56



Deco

Iconic black and white.

- Paperboard construction, covered in smooth laminate paper
- Flocked reversible black and white foam pads
- Packaged in individual white sleeves

Pads are removable and reversible. Choose white flock or black flock.



SCAN THIS CODE ON
YOUR PHONE TO ORDER



CODE	DESCRIPTION	SIZE (inches)	CASE PACK	PRICE/EACH	
				50+	500+
A 31621153D	Ring (R1H)	2 x 2 x 1	50	\$1.95	\$1.79
B 31622153D	Earring (P3)	2 x 2 x 1	50	\$1.95	\$1.79
C 31632153D	Large Earring (P3)	2.5 x 2.5 x 1.75	50	\$2.51	\$2.31
D 31684153D	Utility (P2)	3.75 x 3.75 x 1.5	50	\$4.03	\$3.70
E 31693153D	Bracelet (BL1)	9 x 2 x 1.125	50	\$4.19	\$3.85
F 31673153D	Necklace (N1)	6.5 x 8 x 2	50	\$10.06	\$9.25

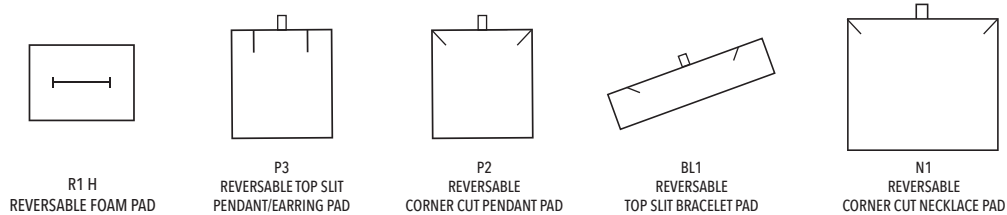

FOIL / PAD PRINT
F: inside and top lid / PP: inside and top lid
50+ 42¢ each
500+ 38¢ each
2500+ 31¢ each

Minimum one case pack.
Please allow 2 - 3 weeks for printed items from approved art.

IN STOCK

Specialty



The Drawer Box

Eco-friendly, on trend series.

- Removable resuede recycled pads
- Fixed ring pad with foam
- Made with 100% recycled paperboard
- Coordinates with the Nano Pouch for a stunning reveal (earring & pendant)



CODE	DESCRIPTION	SIZE (inches)	CASE PACK	PRICE/EACH	
				50+	500+
31050603	Ring (R1)	2.24 x 2.36 x 1.98	50	\$3.08	\$2.47
31070703	Earring Utility	2.75 x 2.83 x 1.57	50	\$3.55	\$2.85
31101003	Pendant Utility	3.93 x 4 x 1.57	50	\$4.64	\$3.71

SCAN THIS CODE ON
YOUR PHONE TO ORDER



PAD PRINT

PP: box top
50+ 42¢ each
500+ 38¢ each
2500+ 31¢ each

Minimum one case pack.
Please allow 2 - 3 weeks for printed items from approved art.

Vision Box

Unique transparent 3D window box with coordinating display stand.

- Transparent puncture resistant elastic film
- Conforms to hold any jewelry piece
- Coordinating display base (extra)



SCAN THIS CODE ON
YOUR PHONE TO ORDER



CODE	DESCRIPTION	SIZE (inches)	PRICE/EACH	
			12+	144+
36301103	Small	2.68 x 2.68 x .75	\$1.26	\$1.01
36302103	Medium	3.5 x 3.5 x .75	\$1.68	\$1.35
36303103	Large	4.25 x 4.25 x .75	\$2.11	\$1.68
69300103	Base (pkg of 12)	2.25 x 2.25 x .62	\$1.05	\$0.84



PAD PRINT

PP: side of lid - text only - limited space
12+ 42¢ each
144+ 38¢ each
504+ 31¢ each

Minimum 12 per style.
Please allow 2 - 3 weeks for printed items from approved art.

All print orders subject to set-up charges. Applicable artwork, and plate charges may apply. See page 98.

All print orders subject to set-up charges. Applicable artwork, and plate charges may apply. See page 98.

IN STOCK

Paperboard Hinged



COORDINATING
EUROTOTE
See pages 56

Royale

Hinged, white paperboard boxes covered in finely ribbed paper with gold accent lines.

- Texture paper wrapped hinged boxes with white flocked foam pads
- Match with Rope Handle Eurototes
- Packaged in individual white sleeves

CODE	DESCRIPTION	SIZE (inches)	CASE PACK	PRICE/EACH	
				50+	1000+
31545003	Ring/Earring (R1H)	2.5 x 2 x 1.5	100	\$1.49	\$1.58
31533003	Pendant/Earring (P2)	2.75 x 2.75 x 1	100	\$1.80	\$1.66
31560003	Utility (P3)	3.5 x 3.5 x 1	50	\$2.67	\$2.55
31580003	Bracelet (BL2)	8.125 x 2.125 x 1	50	\$3.36	\$3.16
31575003	Necklace (N1)	6.5 x 4.5 x 1	50	\$4.77	\$4.48

SCAN THIS CODE ON
YOUR PHONE TO ORDER

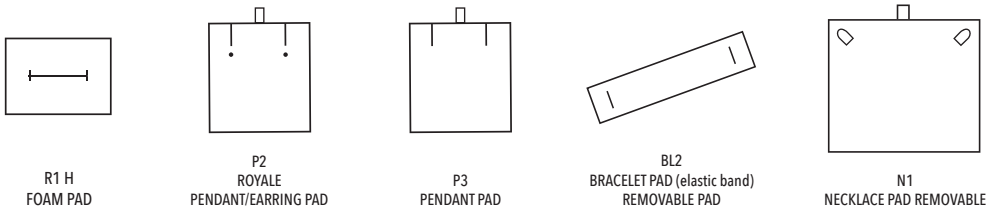

FOIL / PAD PRINT
F: inside and top lid / PP: inside and top lid
50/100+ 42¢ each
1000+ 38¢ each
2500+ 31¢ each

Minimum one case pack.
Please allow 2 - 3 weeks for printed items from approved art.

All print orders subject to set-up charges. Applicable artwork, and plate charges may apply. See page 98.

IN STOCK

2-Piece Boxes



Available Colors



Perfectly partners with
our Whisper series.
As shown here with the
Moonglow hinged boxes.

Mystique

- Texture paper wrapped 2-piece boxes with flocked foam pads
- Packaged in individual white sleeves

CODE	DESCRIPTION	SIZE (inches)	CASE PACK	PRICE/EACH	
				25+	500+
A 31221 _ _ _	Ring (R1)	2.5 x 2.25 x 2	100	\$2.64	\$2.37
B 31222 _ _ _	Earring (EP4)	2 x 1.5 x 1.187	100	\$2.12	\$1.91
C 31263 _ _ _	Utility (P3)	3 x 3 x 2.125	100	\$3.14	\$2.83
D 31293 _ _ _	Bracelet (BL1R)	9 x 2.375 x 1.5	50	\$4.52	\$4.07
E 31273 _ _ _	Necklace (N1)	6.375 x 8 x 2	25	\$6.61	\$5.95

SCAN THIS CODE ON
YOUR PHONE TO ORDER

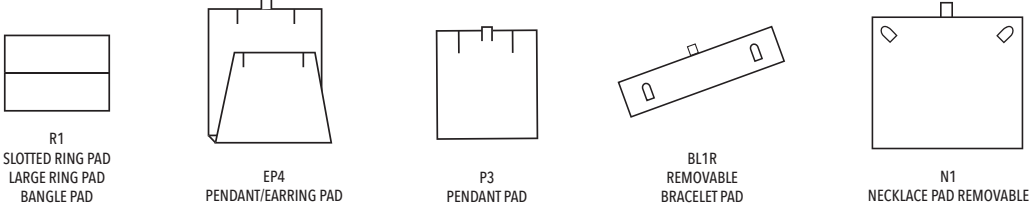

FOIL / PAD PRINT
F: inside and top lid / PP: inside and top lid
50/100+ 42¢ each
1000+ 38¢ each
2500+ 31¢ each

Minimum one case pack.
Please allow 2 - 3 weeks for printed items from approved art.

All print orders subject to set-up charges. Applicable artwork, and plate charges may apply. See page 98.

SPECIAL ORDER

Nest Boxes

Cotton Filled

CODE	PRICE /EACH	
	50+	1000+
31011 ___	\$0.81	\$0.74
31021 ___	\$0.87	\$0.79
31032 ___	\$0.96	\$0.88
31033 ___	\$1.14	\$1.04
31036 ___	\$1.29	\$1.17
31034 ___	\$1.40	\$1.27
31053 ___	\$1.34	\$1.22
31065 ___	\$1.87	\$1.70
31082 ___	\$1.26	\$1.15
31085 ___	\$2.39	\$2.17















Minimum one case pack.
Estimated lead time - Please allow 3 weeks for unprinted items and 4 weeks for printed items from approved art.

FOIL / PAD PRINT
F: top lid only / PP: top lid only
50/100+ 42¢ each
1000+ 38¢ each
2500+ 31¢ each

Mix & Match!

CODE	SIZE (inches)	CASE PACK													
			061 French Floral	000K White Krome	007 Gold Linen	008 Silver Linen	009 Brick Red	029 Cherry Red	354 Fuchsia	353 Blue Ice	045 Black Onyx/ White Canvas	015S Black Swirl	015P Black Pinstripe	055 Black Onyx	
31011 ___	1.75 x 1.125 x .625	100	-	✓	✓	✓	-	-	-	-	-	-	✓	-	
31021 ___	2.5 x 1.5 x .875	100	✓	✓	✓	✓	✓	✓	✓	✓	✓	✓	✓	✓	
31032 ___	3 x 2.125 X 1	100	✓	✓	✓	✓	✓	✓	✓	✓	✓	✓	✓	✓	
31033 ___	3.5 x 3.5 x 1	100	✓	✓	✓	✓	✓	✓	✓	✓	-	✓	✓	✓	
31036 ___	3.5 x 3.5 x 1.5	100	-	✓	✓	✓	-	-	-	-	-	-	✓	✓	
31034 ___	3.5 x 3.5 x 2	100	-	✓	✓	-	-	-	-	-	-	✓	✓	✓	
31053 ___	5.25 x 3.75 x .875	100	✓	✓	✓	✓	✓	✓	✓	✓	✓	✓	✓	✓	
31065 ___	6 x 5 x 1	50	-	✓	✓	✓	✓	✓	✓	-	✓	✓	✓	✓	
31082 ___	8 x 2 x .875	100	-	✓	✓	✓	✓	✓	✓	-	-	✓	✓	✓	
31085 ___	8 x 5.5 x 1.25	50	-	✓	✓	✓	✓	-	-	-	-	✓	✓	-	



			093 Slate Grey	098 Coffee & Cream	099 Cocoa	060 Deep Woods	056 Deep Purple	028 Lilac	025 Tropical Blue	026 Cobalt Blue	076 Oatmeal Groove	075 Kraft	081 Celestial Blue	019 White Sand
CODE	SIZE (inches)	CASE PACK												
31011 ---	1.75 x 1.125 x .625	100	—	—	—	✓	—	—	—	—	✓	✓	—	—
31021 ---	2.5 x 1.5 x .875	100	✓	✓	✓	✓	✓	✓	✓	✓	✓	✓	—	✓
31032 ---	3 x 2.125 X 1	100	✓	✓	✓	✓	✓	✓	✓	✓	✓	✓	✓	✓
31033 ---	3.5 x 3.5 x 1	100	✓	✓	✓	✓	✓	✓	✓	✓	✓	✓	✓	✓
31036 ---	3.5 x 3.5 x 1.5	100	—	—	—	—	✓	—	—	—	✓	✓	—	—
31034 ---	3.5 x 3.5 x 2	100	—	—	—	—	✓	—	✓	—	✓	✓	—	—
31053 ---	5.25 x 3.75 x .875	100	✓	✓	✓	✓	✓	✓	✓	✓	✓	✓	✓	✓
31065 ---	6 x 5 x 1	50	✓	✓	✓	✓	✓	—	✓	✓	✓	✓	✓	—
31082 ---	8 x 2 x .875	100	✓	—	✓	✓	✓	—	—	—	✓	✓	—	—
31085 ---	8 x 5.5 x 1.25	50	—	—	—	✓	—	—	—	—	✓	✓	—	—



Berkeley Series

Four sizes, including one that can accommodate gift cards, are available, each with a white flocked removable platform.

See page 61 for more information and for matching paper bags!
All are recyclable, reusable and biodegradable.



All print orders subject to set-up charges. Applicable artwork, and plate charges may apply. See page 98.

IN STOCK

Nest Boxes



These boxes match our
Damask Paper Shoppers - page 63
and **Damask Pouches** - page 49



Damask

Style and substance in a simple packaging combination.

- Black and white 2-piece box
- 100% recycled board box
- Cotton fill pad wrapped with damask patterned tissue
- See our matching bag and pouch to complete your collection

CODE	DESCRIPTION	SIZE (inches)	CASE PACK	PRICE /EACH	
				100+	1000+
31570153D	Earring	3 x 2.125 x 1	100	\$0.87	\$0.84
31555153D	Brooch	3.5 x 3.5 x 1	100	\$1.06	\$1.01
31564153D	Bracelet	8 x 2 x .875	100	\$1.25	\$1.20
31558153D	Necklace	6 x 5 x 1	100	\$1.81	\$1.74

Minimum order is one case pack.

White Swirl
Pattern



White Economy

Sometimes a simple box is all you need!

- Made with 100% recycled board covered with white swirl paper
- Cotton filled to hold jewelry in place

CODE	DESCRIPTION	SIZE (inches)	CASE PACK	PRICE /EACH	
				50+	1000+
31502103	Charm	2.5 x 1.5 x .875	100	\$0.56	\$0.51
31570103	Earring	3 x 2.125 x 1	100	\$0.59	\$0.53
31555103	Brooch	3.5 x 3.5 x 1	100	\$0.66	\$0.62
31564103	Bracelet	8 x 2 x .875	100	\$0.73	\$0.69
31558103	Necklace	6 x 5 x 1	50	\$1.13	\$1.07
31576103	Large Necklace	8 x 5.5 x 1.25	50	\$1.90	\$1.78
31259103	Stand-Up Bangle	3.5 x 2 x 2 x 2	100	\$2.97	\$2.67

Minimum order is one case pack.



FOIL / PAD PRINT
F: top lid only / PP: top lid only
100+ 42¢ each
1000+ 38¢ each
2500+ 31¢ each

Estimated lead time: 2 - 3 weeks for printed items from approved art.



FOIL / PAD PRINT
F: top lid only / PP: top lid only
50/100+ 42¢ each
1000+ 38¢ each
2500+ 31¢ each

Estimated lead time: 2 - 3 weeks for printed items from approved art.

All print orders subject to set-up charges. Applicable artwork, and plate charges may apply. See page 98.

SPECIAL ORDER

Gift Card Boxes



Monte Carlo Gift Card Box

People love gift cards, this box takes the presentation to a new level.

- Smooth paper hinged box with magnetic closure
- Removable insert holds card securely
- We suggest the black box with our gloss black GL2 print

CODE	SIZE (inches)	CASE	PRICE/EACH
			100+
310239 __	5.125 x 4 x 1	100	\$3.96



FOIL / PAD PRINT
F: inside lid only / PP: inside and outside lid
100+ 42¢ each
1000+ 38¢ each
2500+ 31¢ each
Estimated lead time: 3 weeks for unprinted items and 4 weeks for printed items from approved art.



Gift Card Nest Box

- White paperboard platforms
- Silver or White exterior

CODE	SIZE (inches)	CASE	PRICE/EACH
			100+
313230 __	3.5 x 2.25 x .75	100	\$1.66

Estimated lead time: 3 weeks for unprinted items and 4 weeks for printed items from approved art.



Gift Certificate Box

CODE	SIZE (inches)	CASE PACK	PRICE/EACH
			100+
0922100 _ B	Gift Certificate Box Only see color options 6.625 x 3.25 x .5	100	\$2.09

Gift Certificate Box Color:

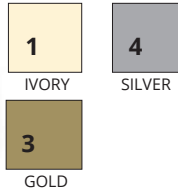

FOIL / PAD PRINT
F and PP: top lid only
100+ 42¢ each
1000+ 38¢ each
2500+ 31¢ each



IN STOCK Finishing Touches

Available to finish the look of your gift certificate/card.

Stretch Loops (100 pack min.)

09500607 6" -	Gold \$0.13/ea
09500608 6" -	Silver \$0.09/ea
09501007 10" -	Gold \$0.14/ea
09501008 10" -	Silver \$0.14/ea



Dress it up with printed ribbon!
See page 90.



IN STOCK

Gift Card Boxes



Black Box with Ribbon

Estimated lead time: 2 - 3 weeks for printed items from approved art.

Minimum order is one case pack.

CODE	SIZE (inches)	CASE	PRICE/EACH	
			100+	1000+
31040315	4 x 3 x .625	100	\$1.61	\$1.25



FOIL / PAD PRINT
F and PP: inside and top lid (TBD)
100+ 42¢ each
1000+ 38¢ each
2500+ 31¢ each



Pewter Box with Ribbon

Estimated lead time: 2 - 3 weeks for printed items from approved art.

Minimum order is one case pack.

CODE	SIZE (inches)	CASE	PRICE/EACH	
			50+	1000+
31040742	7.5 x 4.25 x .625	50	\$2.30	\$2.07



FOIL / PAD PRINT
F and PP: inside and top lid
50+ 42¢ each
1000+ 38¢ each
2500+ 31¢ each



Gift Certificate and Box

Estimated lead time: 2 - 3 weeks for printed items from approved art.

CODE	SIZE (inches)	CASE PACK	PRICE/EACH
			100+
09221002B	White Gift Certificate Box Only	100	\$2.09
18197	English Gift Certificate 6.375 x 3.125" folded	100	\$0.89

Gift certificates are pre-numbered.



FOIL / PAD PRINT
F and PP: certificate and top lid
100+ 42¢ each
1000+ 38¢ each
2500+ 31¢ each

Minimum order is one case pack.

IN STOCK

Pouches

Geo Series

• Minimum case pack 12.

Estimated lead time: 2 - 3 weeks for printed items from approved art.



CODE	TYPE	SIZE (in.)	PRICE /EACH	
			12+	144+
A 09030415B	Geo Pouch with Black Box	3 x 4	\$3.09	\$2.59
B 09030456P	Geo Pouch with Purple Box	3 x 4	\$3.09	\$2.59
C 09030427T	Geo Pouch with Bronze Box	3 x 4	\$3.09	\$2.59

FOIL / PAD PRINT
F and PP: pouch and packer lid
12+ 42¢ each
144+ 38¢ each
504+ 31¢ each

Microfiber

• Minimum case pack 100

CODE	COLOR	SIZE (inches)	PRICE /EACH	
			100+	500+
09040315	Black	4 x 3	\$1.72	\$1.46
09050415	Black	5-1/2 x 4	\$2.41	\$2.06
09040311	Blue	4 x 3	\$1.72	\$1.46
09050411	Blue	5-1/2 x 4	\$2.41	\$2.06

Economical packaging for inexpensive items or repairs.



FOIL / PAD PRINT
F and PP: pouch and packer lid
12+ 42¢ each
144+ 38¢ each
504+ 31¢ each

All print orders subject to set-up charges. Applicable artwork, and plate charges may apply. See page 98.

IN STOCK

Pouches

Damask Pouches



Envelope Pouches with snap closure



Microfiber Bell Pouches +

• Minimum case pack of 12



White Leatherette Pouches



Gold Metallic Pouches



Velveteen Pouches



Wedding Pouches +

White satin pouch with a white 2-piece outer box. • Minimum case pack 12



• Minimum case pack of 100

Assorted Pouches

CODE	TYPE	SIZE (in.)	CASE PACK	PRICE/EACH	
				100+	1000+
A 09040515D	Large Damask Pouch	5.5 x 4	100	\$2.50	\$2.17
B 09030315D	Small Damask Pouch	3 x 3	100	\$1.82	\$1.62
C 09304715	Large Envelope Pouch	3 x 4	100	\$3.45	\$3.28
D 09203715	Small Envelope Pouch	2.375 x 2.75	100	\$2.67	\$2.46
E 09525115B	Large Microfiber Bell Pouch	4.375 x 5.375	12	\$1.72	\$1.47
F 09324115B	Small Microfiber Bell Pouch	3.25 x 4.5	12	\$1.37	\$1.19
G 09314700	Large White Leatherette Pouch	3 x 4	100	\$0.97	\$0.82
H 09203700	Small White Leatherette Pouch	2.75 x 3.25	100	\$0.79	\$0.69
I 09314807	Gold Metallic Pouch	3 x 4	100	\$0.99	\$0.97
J 09405 _ _ _	*Velveteen Pouches	4 x 5.5	100	\$0.71	\$0.59
K 09314 _ _ _	*Velveteen Pouches	3 x 4	100	\$0.59	\$0.49
31314003	White 2-piece outer box**	3.25 x 4.25	100	\$1.01	\$0.92
31065000K	White 2-piece outer box	6 x 5 x 1	50	\$1.87	\$1.70
L 37501006	White Wedding Pouches	1.875 x 2.5	12	\$1.99	\$1.66

* See photo for color code



Estimated lead time: 2 - 3 weeks for printed items from approved art.

FOIL / PAD PRINT
100+ 42¢ each
1000+ 38¢ each
2500+ 31¢ each

+ Bell Pouches and Wedding Pouch minimums:

FOIL / PAD PRINT
12+ 42¢ each
144+ 38¢ each
504+ 31¢ each

All print orders subject to set-up charges. Applicable artwork, and plate charges may apply. See page 98.

SPECIAL ORDER

Jewelry Care

Customize with your store brand!

Quality professional jewelry care, such as LAVISH, starts as an add-on sale or complimentary gift with purchase and keeps customers coming back for more. Every time customers clean their jewelry with customized LAVISH jewelry care, they will think of your store.

SCAN THIS CODE ON YOUR PHONE TO ORDER



Estimated lead time: 3-4 weeks for printed items from approved art.

Available for immediate shipment.



We care about your jewelry as much as you do!



We care about your jewelry, that's why we use better ingredients, better packaging, and you get better performance to keep you sparkling brighter all day long. Use Lavish everyday to safely and conveniently make your jewelry sparkle and shine more than it ever has.

SCAN THIS CODE ON YOUR PHONE TO ORDER



Full Color Digital Printed Labels

Create your own full color look or our artist can create a design for your approval. Estimated lead time: 3 - 4 weeks for custom printed items from approved art.



Lavish Jewelry Bath

8 fl. oz. (236 ml)
04530000C \$4.84 ea
Minimum order 150 jars



Lavish Polishing Cloth

6" x 4" - Slate Grey with Vellum Envelope
04540000C \$4.81 ea

Screen print colors: Black, Silver, Gold or White
Minimum order 200 cloths



Lavish Foam

1.69 fl. oz. (50 ml) 2.5 fl. oz. (75 ml)
04510050C \$5.82 ea **04510075C** \$7.29 ea
Minimum order 96 bottles per size



Lavish Click Clean Pen

.108 fl. oz. (3.2 ml)
04520000C \$6.00 ea
Minimum order 100 pens



Non-Toxic
User and Eco Friendly. Lavish is a bio-based cleaning formula that contains no harsh chemicals, peroxides, phosphates, or ammonia.



Made in the USA
Lavish was developed and is made by a 3rd generation jeweler/jewelry designer whose ambition is to provide you with the safest, and most effective product available.



Biodegradable
Lavish is biodegradable. It breaks down rapidly and completely, meaning it will not contaminate or pollute our water, or our environment.



Safe
Lavish is safe for you, your jewelry, and our planet. From costume jewelry to your heirloom pieces, Lavish will bring back the sparkle and shine without the worry.



Lavish Jewelry Bath

Jewelry bath includes 1 pod of our jewelry cleaner concentrate. An effective jewelry cleaner that can be used on all jewelry from Pearls and Opals to Diamonds without the risk of damage.

8 fl. oz. (236 ml)
04530000 \$4.84 ea
50 per case pack



Lavish Foam

Our Lavish Jewelry Cleaning Foam is our #1 customer favorite product. The foam is a special blend of bio-based surfactants that coalesce in a foam to efficiently break down the daily buildup of grime and allow it to be easy rinsed away leaving nothing but sparkle and shine. The foam is dispensed through a non-aerosol pump foamer, so there are no nasty propellants to damage our ozone layer.

1.69 fl. oz. (50 ml) 2.5 fl. oz. (75 ml)
04510050 \$5.82 ea **04510075** \$7.29 ea
48 per case pack per size



Lavish Click Clean Pen

The Lavish Click Clean Pen is the ultra portable, ultra quick way to put the bling back in your ring. The non-toxic formulation is safe for all your jewelry and is ready to go whenever, wherever you are. The one-handed click action gives you control so you can dispense just the right amount of cleaning solution onto your jewelry. The soft brush tip makes it easy to get into hard to reach areas of your jewelry and underneath stones.

.108 fl. oz. (3.2 ml)
04520000 \$6.00 ea 50 per case pack



Lavish Polishing Cloth

Gold, Silver, Platinum oh my!

Bring back the shine of all your metals with the Lavish signature polishing cloth. Our polishing cloth is infused with a gentle and effective polishing compound that will bring back the luster and shine to your jewelry. Great for use on gold, silver, platinum, and other precious metals.

Note: To avoid the possibility of small scratches, care should be taken to avoid contact with stones other than diamonds. 8 fl. oz. (236 ml)

6" x 4" - Slate Grey with Vellum Envelope
04540000 \$4.81 ea
50 per case pack



Handling Gloves

White microfiber. One size fits all

The natural oils in our skin can often leave displeasing marks on jewelry. Our microfiber, lint-free gloves are ideal for handling and protecting your most precious inventory.

05000296 \$3.03 /pair
Minimum order - 6 pairs



Diamond & Gem Cloths

Microfiber Cloth removes small dust, oily film, fingerprints and other residue from fine jewelry. Chemical Free. Lint Free. AVAILABLE IN LIGHT BLUE ONLY. Estimated lead time: 4 - 6 weeks for custom printed cloths from approved art.

8 x 8" Blue Cloth **04780800C** \$2.92 ea
Minimum order is 144 cloths.

IN STOCK

Jewelry Care

Estimated lead time: 2 - 3 weeks for printed items from approved art.

Repair Envelopes

 **NO PLATE CHARGES!**

CODE	DESCRIPTION	SIZE (in)	1000	3000	5000	10000
A 09850000	2-Part NCR	4.25 x 9	\$0.268	\$0.256	\$0.207	\$0.171
B 09845200	Plain-no perf., text or numbers	3.5 x 6.125	\$0.144	\$0.137	\$0.126	\$0.116
C 09845300	Double Perforated	3.5 x 6.125	\$0.254	\$0.220	\$0.185	\$0.162
D 09845400	Single Perforated	3.5 x 6.125	\$0.254	\$0.220	\$0.185	\$0.162
E 09850000E	2-part NCR - NO PRINT	4.25 x 9	\$0.265	\$0.265	\$0.265	\$0.265

SCAN THIS CODE ON
YOUR PHONE TO ORDER



• Prices include one color printing. A second color is \$ 0.029/each.
Minimum 1000 per style. Printing colors: Black, Red, Green and Blue



Please allow 2 - 3 weeks for printing.
\$37 set-up charge applies.

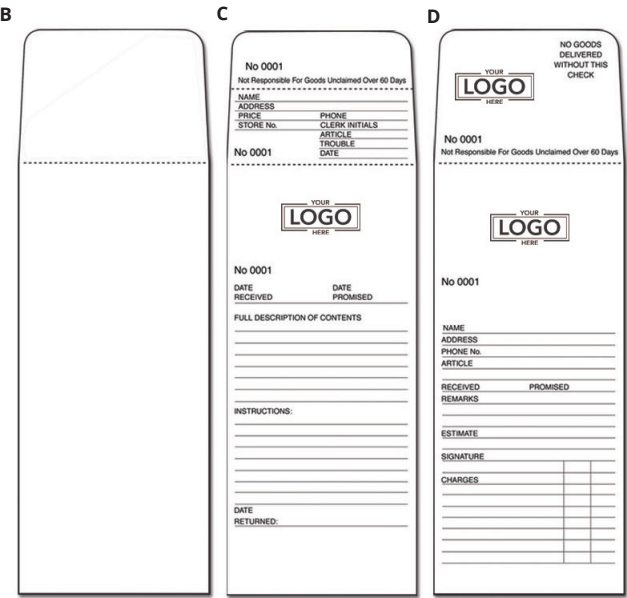

Tags and Miscellaneous Accessories

CODE	DESCRIPTION	PACK MIN.	PRICE
E 08270207	Plastic Ring Tags - Gold	Box/1000	\$132.61
F 08270208	Plastic Ring Tags - Silver	Box/1000	\$132.61
G 08090707	Plastic With String Tags - Gold	Box/1000	\$132.61
H 08090708	Plastic With String Tags - Silver	Box/1000	\$132.61
I 08810800	Super Mylar Ring Tags - Wide	Box/1000	\$50.66
J 08810700	Super Mylar Ring tags - Narrow	Box/1000	\$34.83
08833000	Fine Pen Marker (not shown)	1	\$14.65



SCAN THIS CODE ON
YOUR PHONE TO ORDER



Available for immediate shipping for above items.

All print orders subject to set-up charges. Applicable artwork, and plate charges may apply. See page 98.

BAGS

EUROTOTES, SHOPPERS, CYOL,
REUSABLE & APPAREL



IN STOCK

Rope Handle Eurototes



Vantage II Eurototes
Available Colors



08V - Silver
Matches Vantage Silver
Hinged Packaging
See page 29.

07V - Gold
Matches Vantage Gold
Hinged Packaging
See page 29.



Estimated lead time: 2 - 3 weeks for
printed items from approved art.



FOIL PRINT
100+ 42¢ each
1000+ 38¢ each
2500+ 31¢ each

Eclipse and Geo Eurototes
Available Colors



56G - Purple
Matches Geo Purple
Hinged Packaging
See page 23.

27G - Bronze
Matches Geo Bronze
Hinged Packaging
See page 23.



66E - Aubergine
Matches Eclipse Aubergine
Hinged Packaging
See page 19.

81E - Blue
Matches Eclipse Blue
Hinged Packaging
See page 19.

Shimmer
Paper Detail

Vantage II Eurototes

- 150 gsm uncoated art paper
- 5 mm pp cord knotted handles
- Folded top turn and cardboard reinforced bottom
- Minimum order is 100 per color per size

CODE	SIZE (inches)	PRICE/EACH		
		100+	500+	1000+
A 230606 _ _ _	6 x 3.5 x 6 x 3.5*	\$1.48	\$1.36	\$1.17
B 231008 _ _ _	10.5 x 5 x 8.5 x 5	\$1.88	\$1.68	\$1.45

* 07V-Gold is not available in this size.



Eclipse and Geo Eurototes

- 150 gsm uncoated art paper
- 5 mm pp cord knotted handles
- Folded top turn and cardboard reinforced bottom
- Minimum order is 100 per color per size

All print orders subject to set-up charges. Applicable artwork, and plate charges may apply. See page 98.

IN STOCK

Luxury Grosgrain Handle Eurototes



Luxury Grosgrain Handle Eurototes

- Gloss and matte lamination
- 157 gsm art paper
- 7/8" matching grosgrain, knotted handles
- Fold over top turn and cardboard reinforced bottom
- Minimum order is 100 per color per size

CODE	SIZE (inches)	CASE PACK	PRICE/EACH		
			100+	500+	1000+
A 230606 _ _ _	6 x 3 x 6 x 3	100	\$1.32	\$1.18	\$1.02
B 230810 _ _ _	8 x 4 x 10 x 4	100	\$1.39	\$1.25	\$1.07
C 231209 _ _ _	12.5 x 4.5 x 9 x 4.5	100	\$1.67	\$1.50	\$1.29
D 231612 _ _ _	16 x 6 x 12 x 6	100	\$2.26	\$2.04	\$1.76
E 232014 _ _ _*	20 x 6 x 14 x 6	100	\$2.54	\$2.28	\$1.96

* champagne and pewter not available in this size.

Estimated lead time: 2 - 3 weeks for
printed items from approved art.



FOIL PRINT
100+ 42¢ each
1000+ 38¢ each
2500+ 31¢ each



TRANSFER PRINT
100+ \$2.45 each
1000+ \$2.25 each
300 bags minimum

Available Colors



All print orders subject to set-up charges. Applicable artwork, and plate charges may apply. See page 98.

IN STOCK

Eco-Lux Eurototes



Eco-Lux Eurototes

- 150 gsm recyclable art paper
- 5 mm polypropylene rope handle
- Folded top turn and cardboard reinforced bottom
- Minimum order is 100 per color per size

CODE	TYPE	SIZE (inches)	CASE PACK	PRICE/EACH		
				100+	500+	1000+
A 239606 __	Novelty	6 x 3.5 x 6 x 3.5	100	\$1.37	\$1.21	\$1.15
B 239709 __	Small gift	9 x 3.5 x 7 x 3.5	100	\$1.61	\$1.40	\$1.33
C 239810 __	Gift	8 x 4 x 10 x 4	100	\$1.72	\$1.56	\$1.43
D 230908 __ T	Trapezoid	9/7 x 4 x 8.5 x 4	100	\$1.93	\$1.69	\$1.62
E 238116 __	Fashion	16 x 6 x 12 x 6	100	\$3.03	\$2.66	\$2.55
F 231011 __	Watch	10 x 5 x 11 x 5	100	\$1.94	\$1.65	\$1.56

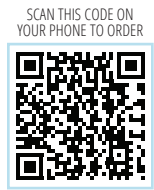

Estimated lead time: 2 - 3 weeks for printed items from approved art.



FOIL PRINT
100+ 42¢ each
1000+ 38¢ each
2500+ 31¢ each



DIGITAL PRINT*
39¢ each



TRANSFER PRINT
100+ \$2.45 each
1000+ \$2.25 each
300 bags minimum

*Best printed on white.



	15-Black	00-White	07-Gold	08-Silver	42-Chestnut	11-Blue	10-Green
Novelty	✓	✓	✓	✓	✓	✓	✓
Small Gift	✓	✓	✓	✓	✓	✓	✓
Gift	✓	✓	✓	✓	✓	✓	✓
Trapezoid	✓	✓	✓	—	✓	—	—
Fashion	✓	✓	✓	✓	✓	—	—
Watch	✓	✓	✓	—	—	—	—

All print orders subject to set-up charges. Applicable artwork, and plate charges may apply. See page 98.

IN STOCK

All Paper Eurototes



All Paper Eurotote with Paper Rope Handle

- 100% recyclable
- 40% post-consumer waste
- 190 gsm uncoated paper
- 8 mm paper cord knotted handles
- Folded top turn and cardboard reinforced bottom
- Minimum order is 100 per color per size



CODE	SIZE (inches)	CASE PACK	PRICE/EACH		
			100+	500+	1000+
A 230606 _ _ _ _	6 x 3.5 x 6 x 3.5	100			
B 230810 _ _ _ _	8 x 4 x 10 x 4	100			
C 231013 _ _ _ _	10 x 5 x 13 x 5	100			
D 231612 _ _ _ _	16 x 6 x 12 x 6	100			

Estimated lead time: 2 - 3 weeks for printed items from approved art.
*Black bags cannot be digital printed.



FOIL PRINT
100+ 42¢ each
1000+ 38¢ each
2500+ 31¢ each



DIGITAL PRINT
39¢ each

*Best printed on kraft, white and cream bags.

Available Colors



All print orders subject to set-up charges. Applicable artwork, and plate charges may apply. See page 98.

CREATE YOUR OWN LOOK

Full Color Paper Eurototes

Make a creative impression...
the combinations are endless!



Prices include up to 2 ink print colors:

TYPE	SIZE (inches)
Novelty	6 x 3.5 x 6 x 3.5
Small Gift	9 x 3.5 x 7 x 3.5
Gift	8 x 4 x 10 x 4
Trapezoid	9/7 x 4 x 8.5 x 4
Wine	3.375 x 3.5 x 13 x 3.5
Fashion	16 x 6 x 12 x 6
Saville	16 x 6 x 19 x 6

Prices include 4 color process print:

TYPE	SIZE (inches)
Novelty	6 x 3.5 x 6 x 3.5
Small Gift	9 x 3.5 x 7 x 3.5
Gift	8 x 4 x 10 x 4
Trapezoid	9/7 x 4 x 8.5 x 4
Wine	3.375 x 3.5 x 13 x 3.5
Fashion	16 x 6 x 12 x 6
Saville	16 x 6 x 19 x 6

- Combination foil print and ink printing available.
- No charge for printing plates (proof charge applies)
- Substitute a satin ribbon handle for the standard rope
- Add metal grommets to your bag



Unique printing
options available.

Double Stamping
shown here.



Create Your Own Look:

Choose your bag style.
Send us your artwork.
For 100% full color
design, speak to your
sales representative.

SPECIAL ORDER



Manhattan Eurototes

- Made with 40% PCW*
- Made with 75% PCW**
- Biodegradable
- 5/8" poly/cotton twill knotted handle
- Recyclable once handle has been removed
- Folded top turn and cardboard reinforced bottom

SCAN THIS CODE ON
YOUR PHONE TO ORDER



12" Wide Gussets!



CODE	TYPE	CASE	PRICE/EACH		
			100+	500+	1000+
A 245845 __	Mini	100	\$1.46	\$1.40	\$1.33
B 245841 __	Petite	100	\$1.83	\$1.76	\$1.66
C 245843 __	Vanity	100	\$2.32	\$2.23	\$2.11
D 245844 __	Fashion	100	\$3.18	\$3.05	\$2.90
E 245860 __	X-Large	50	\$4.91	\$4.72	\$4.47
F 245898 __	Bottle Bag	100	\$2.01	\$1.92	\$1.83

CODE	TYPE	CASE	PRICE/EACH		
			100+	500+	1000+
24585615	Medium - Black	100	\$6.55	\$6.28	\$5.96
24585715	Large - Black	100	\$7.48	\$7.19	\$6.81
24585600	Medium - White	100	\$6.55	\$6.28	\$5.96
24585700	Large - White	100	\$7.48	\$7.19	\$6.81
24585675	Medium - Kraft	100	\$6.55	\$6.28	\$5.96
24585775	Large - Kraft	100	\$7.48	\$7.19	\$6.81

Available
Colors



Estimated lead time: 3 - 5
weeks for printed items
from approved art.



FOIL PRINT

100+ 42¢ each
1000+ 38¢ each
2500+ 31¢ each



TRANSFER PRINT

100+ \$2.45 each
1000+ \$2.25 each
300 bags minimum

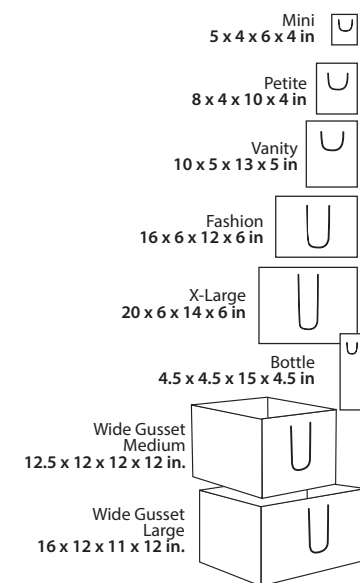

	15* Black	00* White	75** Kraft	08* Grey	09* Red	41* Fuchsia	11** Navy	61* Green
Mini 5 x 4 x 6 x 4 in	✓	✓	✓	✓	✓	✓	✓	✓
Petite 8 x 4 x 10 x 4 in	✓	✓	✓	✓	✓	✓	✓	✓
Vanity 10 x 5 x 13 x 5 in	✓	✓	✓	✓	✓	✓	✓	✓
Fashion 16 x 6 x 12 x 6 in	✓	✓	✓	✓	✓	✓	✓	✓
X-Large 20 x 6 x 14 x 6 in	✓	✓	✓	—	—	—	—	—
Bottle 4.5 x 4.5 x 15 x 4.5 in	✓	✓	✓	—	✓	—	—	—
Wide Gusset Medium 12.5 x 12 x 12 x 12 in	✓	✓	✓	—	—	—	—	—
Wide Gusset Large 16 x 12 x 11 x 12 in	✓	✓	✓	—	—	—	—	—

All print orders subject to set-up charges. Applicable artwork, and plate charges may apply. See page 98.

All print orders subject to set-up charges. Applicable artwork, and plate charges may apply. See page 98.

SPECIAL ORDER



Thick Woven Handle Detail

Available Colors



15 Black/Gloss Black 08 Silver/Gloss Silver 00 White/Gloss Silver

5th Avenue Eurototes

- Embossed laminated finish with printed gloss and coordinating color interior, 210 gsm
- Woven handles, top slit style, W fold bottom with removable bottom board
- Minimum order is 100 per color per size

CODE	SIZE (inches)	CASE PACK	PRICE/EACH	
			100+	1000+
A 245820 __	8 x 3.5 x 6 x 3.5	100	\$4.02	\$3.76
B 245821 __	12.5 x 4.5 x 9 x 4.5	100	\$6.37	\$6.02
C 245822 __	17 x 6 x 12.75 x 6	100	\$8.70	\$8.18



SCAN THIS CODE ON YOUR PHONE TO ORDER



FOIL PRINT
100+ 42¢ each
1000+ 38¢ each
2500+ 31¢ each



TRANSFER PRINT
100+ \$2.45 each
1000+ \$2.25 each
300 bags minimum



Tints and Pinstripe on Kraft

- Twist paper handle
- 120 gsm paper



SCAN THIS CODE ON YOUR PHONE TO ORDER



Pinstripe Detail

Tints on Kraft



Pinstripe on Kraft



TRANSFER PRINT
250+ \$2.45 each
1000+ \$2.25 each
300 bags minimum



INK PRINT
250+ 34¢ each
1000+ 29¢ each
2500+ 24¢ each

Estimated lead time:
Approx. 6 weeks for No Print Bags.
Approx 8 - 10 weeks for Printed items from approved art.



FOIL PRINT
250+ 42¢ each
1000+ 38¢ each
2500+ 31¢ each

All print orders subject to set-up charges. Applicable artwork, and plate charges may apply. See page 98.

SPECIAL ORDER

Paper Shoppers



Available Colors



15 Black 00 White 75 Kraft 09 Red

San Fran Natural Shoppers

Simple yet striking keyline design collection

- Limited colors and quantities remain

CODE	SIZE (inches)	CASE PACK	PRICE/EACH		
			100+	500+	1000+
249703 __	7 x 3 x 7 x 3	100	\$1.54	\$1.48	\$1.43
249704 __	10 x 4 x 10 x 4	100	\$2.00	\$1.93	\$1.86
249711 __	16 x 6 x 12 x 6	100	\$2.91	\$2.81	\$2.71

Please refer to website for remaining sizes and colors.



FOIL PRINT
100+ 42¢ each
1000+ 38¢ each
2500+ 31¢ each



DIGITAL PRINT
Only on white and kraft.
39¢ each



TRANSFER PRINT
100+ \$2.45 each
1000+ \$2.25 each
300 bags minimum



INK PRINT
100+ 34¢ each
1000+ 29¢ each
2500+ 24¢ each

*Best printed on white and kraft bags.



SCAN THIS CODE ON YOUR PHONE TO ORDER



100% Recyclable

Please allow 2 - 3 weeks for printed items from approved art.

Berkeley Nest Boxes

Coordinating with San Fran Natural Shoppers, these 2-piece boxes finish the look.

- Glossy paper
- White flocked platform inserts
- Limited colors and quantities remain

CODE	SIZE (inches)	CASE PACK	PRICE/EACH	
			100+	1000+
32201 __	3 x 3 x 1.25	100	\$2.41	\$2.21
32204 __	9 x 4.5 x 2	100	\$4.55	\$3.96

Please refer to website for remaining sizes and colors.



FOIL / PAD PRINT
F: top lid only / PP: top lid only
100+ 42¢ each
1000+ 38¢ each
2500+ 31¢ each

Minimum one case pack.
Estimated lead time - Please allow 3 weeks for unprinted items and 4 weeks for printed items from approved art.

Available Colors

192 - Solid White



100% Recycled Board

SCAN THIS CODE ON YOUR PHONE TO ORDER



All print orders subject to set-up charges. Applicable artwork, and plate charges may apply. See page 98.

CREATE YOUR OWN LOOK

Full Color Simply Paper Shoppers

Make a creative impression...
the combinations are endless!



Simply Paper Shoppers

Kraft with paper twist handles, print 1 color on 2 sides <25%

TYPE	SIZE (inches)	CASE PACK
Prime	5.25 x 3.5 x 8.25	250
Petite	8 x 4 x 10	250
Vanity	10 x 5 x 13	250
Celebrity	13 x 6 x 15.5	250
Fashion	16 x 6 x 12	250
Saville	16 x 6 x 19	200
Universal	18 x 6 x 19	200
Wine	5.25 x 3.5 x 13	250

Any 2 Sizes
Minimum 3000
Special Pricing

White with paper twist handles, print 1 color on 2 sides <25%

TYPE	SIZE (inches)	CASE PACK
Prime	5.25 x 3.5 x 8.25	250
Petite	8 x 4 x 10	250
Vanity	10 x 5 x 13	250
Celebrity	13 x 6 x 15.5	250
Fashion	16 x 6 x 12	250
Saville	16 x 6 x 19	200
Universal	18 x 6 x 19	200
Wine	5.25 x 3.5 x 13	250

Any 2 Sizes
Minimum 3000
Special Pricing



Create Your Own Look:
Choose your bag style.
Send us your artwork.
For 100% full color
design, speak to your
sales representative.



96% Recycled Material

- Minimum 5,000 per size or any 2 sizes, minimum 3000 per size
 - Add a second color
 - Go 100% ink coverage
 - Add a rope handle
- Estimated lead time: 12 - 14 weeks for printed items from approved art.

IN STOCK Paper Shoppers



90%
Post Consumer
Waste



100% Recyclable

SCAN THIS CODE ON
YOUR PHONE TO ORDER



Paper Twist Handle Shopping Bags

- 100% recyclable
- Kraft: 90% post-consumer waste/ White: 100% virgin paper
- 110 gsm paper
- Minimum order is 250/200 per color per size

CODE	TYPE	SIZE (inches)	CASE	12 - Kraft PRICE/EACH		00 - White PRICE/EACH		Tints PRICE/EACH		Metallics PRICE/EACH	
				250+	1000+	250+	1000+	250+	1000+	250+	1000+
230508_ _ *	Prime	5 x 3.5 x 8 x 3.5	250	\$0.42	\$0.36	\$0.52	\$0.41	\$0.86	\$0.72	\$0.93	\$0.79
230809_ _	Petite	8 x 4.5 x 10.75 x 4.5	250	\$0.48	\$0.42	\$0.52	\$0.46	\$0.89	\$0.81	\$0.98	\$0.88
230914_ _	Vanity	10 x 5 x 13 x 5	250	\$0.75	\$0.51	\$0.58	\$0.52	—	—	—	—
231315_ _	Celebrity	13 x 6 x 15 x 6	250	\$0.60	\$0.56	\$0.69	\$0.64	—	—	—	—
231611_ _	Fashion	16 x 6 x 12 x 6	250	\$0.59	\$0.56	\$0.64	\$0.58	\$0.88	\$0.77	\$1.47	\$1.34
231619_ _	Saville	16 x 6 x 19 x 6	**	\$0.75	\$0.65	\$0.87	\$0.77	\$1.19	\$1.08	\$2.19	\$2.03
231819_ _	Universal	18 x 7 x 18.75 x 7	200	\$0.78	\$0.69	\$0.84	\$1.04	—	—	—	—
230513_ _	Wine Shopper	5.25 x 3.5 x 13	250	\$0.87	\$0.81	\$0.89	\$0.84	—	—	—	—

Available Colors		12- Kraft	00- White	35- Black	41 - Navy	07 - Gold	08- Silver
Prime		✓	✓	✓	✓	✓	✓
Petite		✓	✓	✓	✓	✓	✓
Vanity		✓	✓	—	—	—	—
Celebrity		✓	✓	—	—	—	—
Fashion		✓	✓	✓	✓	✓	✓
Saville		✓	✓	✓	✓	✓	✓
Universal		✓	✓	✓	✓	✓	✓
Wine		✓	✓	—	—	—	—

* White and Kraft is 230508_ _P
* Black, Navy, Gold and Silver 230508_ _PR
** White and Kraft are sold in case packs of 200 and the Black, Navy, Gold and Silver are sold in case packs of 250

Sturdy, durable.
Our best value bags.



FOIL PRINT
100+ 42¢ each
1000+ 38¢ each
2500+ 31¢ each



DIGITAL PRINT
Only on white and kraft.
39¢ each



TRANSFER PRINT
100+ \$2.45 each
1000+ \$2.25 each
300 bags minimum



INK PRINT
100+ 34¢ each
1000+ 29¢ each
2500+ 24¢ each

Please allow 2 - 3 weeks for printed items from approved art.
*Best printed on kraft, white, gold and silver bags.

IN STOCK

Paper Shoppers

The Mission Green Sustainable Solution for single-use plastic merchandise shoppers.



Please allow 2 - 3 weeks for printed items from approved art.



FOIL PRINT
100+ 42¢ each
1000+ 38¢ each
2500+ 31¢ each



DIGITAL PRINT
39¢ each



TRANSFER PRINT
100+ \$2.45 each
1000+ \$2.25 each
300 bags minimum



INK PRINT
100+ 34¢ each
1000+ 29¢ each
2500+ 24¢ each

Merchandise Die Cut Bags

- Reinforced fold-over handle plus side gusset
- 80 gsm paper

CODE	SIZE (inches)	CASE PACK	PRICE/EACH
23081275	8 x 2 x 12	500	\$0.48
23101575	10 x 2 x 15	500	\$0.52
23141875	14 x 4 x 18	250	\$0.73



Merchandise Bags

- 110 gsm paper

CODE	SIZE (in)	CASE	75 - Kraft PRICE/EACH	00 - White PRICE/EACH
230609 __	6 x 9	2000	\$0.06	\$0.11
230710 __	7 x 10	500	\$0.10	\$0.11
230912 __	9 x 12	500	\$0.11	\$0.16
231114 __	11 x 14	500	\$0.14	\$0.20
231316 __	13 x 16	500	\$0.21	\$0.28



FOIL PRINT
100+ 42¢ each
1000+ 38¢ each
2500+ 31¢ each



DIGITAL PRINT
39¢ each



TRANSFER PRINT
100+ \$2.45 each
1000+ \$2.25 each
300 bags minimum



INK PRINT
100+ 34¢ each
1000+ 29¢ each
2500+ 24¢ each

Please allow 2 - 3 weeks for printed items from approved art.

IN STOCK

Food Service Paper



Tamper Proof Strips
Across Both Sets of Handles



Food Service Kraft Paper Shoppers

- Sturdy and durable
- 110 gsm
- Made from 100% recycled kraft paper

CODE	DESCRIPTION	SIZE (inches)	CASE PACK	PRICE/EACH	
				250+	1000+
A 23121775F	SOS Shopper	12 x 7 x 17 x 7	250	\$0.26	\$0.23
B 23141512F	Paper Twist with Tamper Tape	14 x 10 x 15.5 x 10	200	\$0.79	\$0.68



Please allow 2 - 3 weeks for printed items from approved art.



FOIL PRINT
100+ 42¢ each
1000+ 38¢ each
2500+ 31¢ each



DIGITAL PRINT
39¢ each



TRANSFER PRINT
100+ \$2.45 each
1000+ \$2.25 each
300 bags minimum



INK PRINT
100+ 34¢ each
1000+ 29¢ each
2500+ 24¢ each

All print orders subject to set-up charges. Applicable artwork, and plate charges may apply. See page 98.

CREATE YOUR OWN LOOK

Natural Jute/Cotton Bags

- 22" long and 1" width natural flat jute cotton handle

SIZE (inches)	PRICE/EACH			
	500+	1000+	2000+	5000+
16 x 14 x 3	Contact your representative for pricing.			



3" Bottom Gusset

Laminated Jute Bags

- 18" long and 1.5" width white cotton flat twill handle

SIZE (inches)	PRICE/EACH			
	500+	1000+	2000+	5000+
8 x 8	Contact your representative for pricing.			

White Cotton Handle



Markin Cotton Canvas Bags

- 24" long and 1" width Markin canvas flat handle

SIZE (inches)	PRICE/EACH			
	500+	1000+	2000+	5000+
12 x 16	Contact your representative for pricing.			



All Canvas

Mix Medium Jute Bags

- 12" long and 1" width Buffalo leather flat handle
- Top trim Joco fabrics in upper and lower portion of body
- Canvas cloth piping in the border of stitching
- Laminated

SIZE (inches)	PRICE/EACH			
	500+	1000+	2000+	5000+
16 x 18 x 6	Contact your representative for pricing.			



Tube Handle Natural Jute Laminated Bags

- 15" Round Tube Handle

SIZE (inches)	PRICE/EACH			
	500+	1000+	2000+	5000+
8 x 8	Contact your representative for pricing.			



Flat Handle Natural Jute Laminated Bags

- 16" long & 1.5" width jute flat handle

SIZE (inches)	PRICE/EACH			
	500+	1000+	2000+	5000+
12 x 16	Contact your representative for pricing.			



IN STOCK

Ultrasonic

New



Ultrasonic Bag

- 110 GSM
- PP non woven
- Heat sealed construction – no stitching
- Durable

CODE	SIZE (inches)	CASE PACK	PRICE/EACH	
			100+	1000+
21091101	9 x 5 x 11	100	\$0.71	\$0.54
21161401	16 x 6 x 14	100	\$1.10	\$0.85

SCAN THIS CODE ON
YOUR PHONE TO ORDER



DIGITAL PRINT
39¢ each

Please allow 2 - 3 weeks for printed items from approved art.



FOIL PRINT - TBD
100+ 42¢ each
1000+ 38¢ each
2500+ 31¢ each



SCREEN PRINT
100+ \$1.25 each
500+ \$1.08 each
1000+ 90¢ each

Please allow 2 - 3 weeks for printed items from approved art.

All print orders subject to set-up charges. Applicable artwork, and plate charges may apply. See page 98.

IN STOCK

Reusable RPET

New



15 - Black



00 - White

RPET is known as Recycled Polyethylene Terephthalate. It's a strong, durable material constructed from 80% recycled plastic bottles.



80% Recycled PET

SCAN THIS CODE ON
YOUR PHONE TO ORDER



All print orders subject to set-up charges. Applicable artwork, and plate charges may apply. See page 98.

CREATE YOUR OWN LOOK

Reusable Fabric Style Shoppers

Make a creative impression...
the combinations are endless!



Full Color Laminated Bags

- Plates extra per design/side.
Additions for extra charge
- Add matte lamination /bag
 - Add a carded bottom /bag
 - Zipper top /bag
 - Gusset print /bag

Shopping Bags (inches)

- 9 x 4 x 11 x 4
- 11 1/4 x 4 1/4 x 12 x 4 1/4
- 14 x 4 x 16 x 4
- 16 x 6 x 12 x 6
- 16 x 5 x 15 x 5

80 GSM NON-WOVEN
SILK SCREEN PRINT ONE COLOR 2 SIDES
1"x24" HANDLES - "X" STITCH

100 GSM NON-WOVEN WITH LAMINATION
PRINT 4 COLOR PROCESS
1"x24" PP WEBBING HANDLES - "X" STITCH



Non-woven Polypropylene

Soft, yet durable. Use
this for light to medi-
um weight loads.



Woven Polypropylene

Our strongest material.
This rigid weave will
handle heavy items.

120 GSM PP WOVEN WITH LAMINATION
PRINT 4 COLOR PROCESS
1"x24" PP WEBBING HANDLES - "X" STITCH

Many more
sizes available
- just ask!



Create Your Own Look:
Choose your bag style.
Send us your artwork.
For 100% full color
design, speak to your
sales representative.

- Minimum quantity 2,000 per size
- Estimated lead time: 14 - 16 weeks
for printed items from approved art.



CODE	DESCRIPTION	SIZE (inches)	CASE PACK	PRICE/EACH	
				100+	1000+
A 21141615B	Black Tote with 4" gusset	14 x 4 x 16 x 4	100	\$2.16	\$1.54
B 21111315BW	Six Bottle Wine Tote	11.5 x 7.25 x 13 x 7.25	100	\$3.02	\$2.69
C 21141655B	Black Tote with 8" gusset	14 x 8 x 16 x 8	100	\$2.32	\$1.70
D 21141609R	Red Tote with 8" gusset	14 x 8 x 16 x 8	100	\$2.32	\$1.70
E 21141675C	Large Kraft Composite Tote	14 x 6 x 16 x 6	100	\$2.79	\$2.42
F 21081075C	Small Kraft Composite Tote	8 x 4 x 10 x 4	100	\$1.86	\$1.48

FOIL PRINT
100+ 42¢ each
1000+ 38¢ each
2500+ 31¢ each

SCREEN PRINT
100+ \$1.25 each
500+ \$1.08 each
1000+ 90¢ each

TRANSFER PRINT
100+ \$2.45 each
1000+ \$2.25 each
300 bags minimum

Estimated lead time:
2 - 3 weeks for printed
items from approved art.

IN STOCK

Non-Woven
Garment Covers

Great for resale or promotions!

CODE	SIZE (inches)	CASE PACK	PRICE/EACH UNPRINTED
A 21244015	24 x 42	100	\$3.69
B 21245415	24 x 54	100	\$4.64
C 21247215	24 x 72 + 4	100	\$8.75

Silk screen set-up charge: \$75.00

Please allow 2-3 weeks for printed items from approved art.



SCREEN PRINT
100+ \$1.25 each
500+ \$1.08 each
1000+ 90¢ each



In Stock
One roll, white with no print
\$208.95 any size
21214000S and 21215400S

CREATE
YOUR OWN LOOK

Non-Woven
Garment Covers

Custom Colors Available

SIZE	DESCRIPTION
24 x 42	Suit Bag
24 x 54	Coat Bag
24 x 72 + 4	Gown - Black

Please allow 14 - 16 weeks from approved art for delivery.
Minimum 1000 per size.

Pricing includes printing on one side with one color.



BOXES
GIFT AND APPAREL



All print orders subject to set-up charges. Applicable artwork, and plate charges may apply. See page 98.

IN STOCK

Rigid Collapsible Boxes



Ships flat and assembles without the use of peel and stick tape.

- 100% recyclable gift box
- 70% less storage space than rigid box
- Keepsake

CODE	DESCRIPTION	SIZE (in)	CASE PACK	PRICE/EACH	
				50+	500+
45090800	Small	9.25 x 8.5 x 4.25	50	\$5.07	\$4.53
45141000	Medium	14.5 x 10.5 x 4.25	50	\$7.96	\$7.29
45161200	Large	16 x 12 x 6.25	50	\$10.61	\$7.73



All 3 sizes fit inside our 3 sizes of Gift Ecomm boxes.



FOIL PRINT
Exterior and interior lid
40/60/100+ 42¢ each
1000+ 38¢ each
2500+ 31¢ each



DIGITAL PRINT
39¢ each



INK PRINT
25/50/100+ 34¢ each
1000+ 29¢ each
2500+ 24¢ each



Please allow 3-5 weeks for printed items from approved art.

All print orders subject to set-up charges. Applicable artwork, and plate charges may apply. See page 98.

IN STOCK

White Foldings

- Our most economical option ships flat and stores flat
- Please allow 2 - 3 weeks for printed items from approved art



Please allow 2 - 3 weeks for printed items from approved art.



FOIL PRINT
50/100+ 42¢ each
1000+ 38¢ each
2500+ 31¢ each



INK PRINT
50/100+ 34¢ each
1000+ 29¢ each
2500+ 24¢ each

CODE	DESCRIPTION	SIZE (inches)	CASE	PRICE/EACH	
				100+	1000+
32058003	G58 Baby Mugs	3.5 x 3.5 x 2	100	\$0.35	\$0.32
32001003	G1 Mugs	4 x 4 x 4	100	\$0.37	\$0.34
32002003	G2 Cups and Saucers	6 x 6 x 4	100	\$0.52	\$0.44
32043003	G43 Bowls, etc.	10 x 8 x 4	100	\$0.74	\$0.69
32033003	G33 Bowls, etc.	10 x 10 x 6	100	\$1.72	\$1.53
32005003	G5 Teapots, etc.	8 x 8 x 5	100	\$1.06	\$0.95
32006003	G6 Teapots, etc.	8 x 8 x 8	100	\$1.55	\$1.39
32048003	G48 Fork, Knife, Spoon	13 x 4 x 2	100	\$1.33	\$1.20
32036003	G36 Casseroles	11 x 11 x 4.5	100	\$1.56	\$1.39
32013003	G13 Plates	5 x 5 x 2	100	\$0.50	\$0.43
32004003	G4 Plates	8 x 8 x 2	100	\$0.89	\$0.75
32008003	G8 Plates	11 x 11 x 2	100	\$1.06	\$0.95
32009003	G9 Plates	13.5 x 13.5 x 2	100	\$1.45	\$1.33
32040003	G40 Plates	15 x 15 x 2	100	\$2.03	\$1.84
32003003	G3 All purpose	7 x 4 x 3	100	\$0.62	\$0.56
32010003	G10 All purpose	9 x 4.5 x 4.5	100	\$0.68	\$0.60
32038003	G38 All purpose	12 x 4 x 4	100	\$0.87	\$0.79
32041003	G41 All purpose	10 x 7 x 7	100	\$1.27	\$1.20
32124003	G24* 2-Piece Boxes - Base	6 x 6 x 10	100	\$0.59	\$0.54
	G24* 2-Piece Boxes - Lid		100	\$0.59	\$0.54

* Must be ordered together. Pricing shown is for base and lid combined.

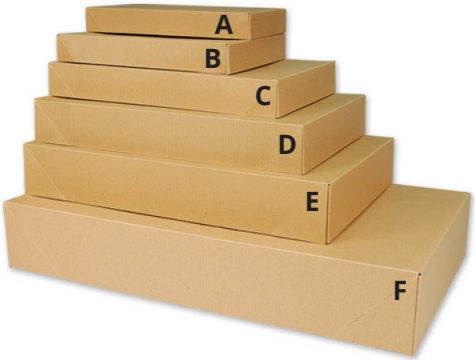

Apparel Boxes

- Minimum order quantity is one case pack
- Please allow 2 - 3 weeks for printed in stock boxes from approved art

IN STOCK COLORS

003	075	153
WHITE	KRAFT PINSTRIPE	BLACK GLOSS

SPECIAL ORDER COLORS

009	For Special Order, please allow 3-5 weeks for printed boxes from approved art.
HOLIDAY RED GLOSS	

CODE	DESCRIPTION	CASE SIZE (inches)	PACK	WHITE PRICE /EACH		KRAFT PINSTRIPE PRICE/EACH		COLORS PRICE/EACH	
				100+	1000+	100+	1000+	100+	1000+
A 32072	Glove/Sock*	11.5 x 5.5 x 1.5	100	\$1.07	\$0.89	\$1.19	\$0.99	—	—
B 32073	Lingerie/T-Shirt	11.5 x 8.5 x 1.625	100	\$1.20	\$1.00	\$1.24	\$1.04	\$2.17	\$1.81
C 32075	Shirt	15 x 9.5 x 2	100	\$1.32	\$1.10	\$1.40	\$1.17	\$3.02	\$2.52
D 32076	Sweater/Dress	17 x 11 x 2.5	50	\$2.23	\$1.86	\$2.35	\$1.96	\$4.21	\$3.51
E 32077	Jacket/Robe	19 x 12 x 3	50	\$2.97	\$2.47	\$2.76	\$2.39	\$4.85	\$4.20
F 32078	Coat/Gown**	24 x 14 x 4	25	\$4.73	\$4.09	\$4.97	\$4.30	\$7.31	\$6.32
G 32071	Sweater (white only) (not shown)	15 x 11 x 4.5	50	\$3.58	\$3.10	—	—	—	—



FOIL PRINT
25/50/100+ 42¢ each
1000+ 38¢ each
2500+ 31¢ each



INK PRINT
25/50/100+ 34¢ each
1000+ 29¢ each
2500+ 24¢ each

* Kraft pinstripe and White only ** Not available in Black

Please allow 2 - 3 weeks for printed in stock boxes from approved art.

All print orders subject to set-up charges. Applicable artwork, and plate charges may apply. See page 98.

SPECIAL ORDER

Malibu Magnetic Closure Gift Box

Dual purpose - great for gifting and use after.
Perfect for e-commerce business subscription.

- Smooth paper covering
- Magnetic closures
- Three colors and three sizes
- Inserts available via special order. Ask your representative

CODE	DESCRIPTION	SIZE (in)	CASE PACK	PRICE/EACH 40+
454103 __	Small	8.5 x 2.75 x 1.625	100	
454104 __	Medium	7.25 x 5.5 x 1.375	60	
454116 __	Large	10.75 x 7.125 x 1.625	40	

HAS BEEN DISCONTINUED
- NO LONGER AVAILABLE



Please allow 3-5 weeks for printed items from approved art.



FOIL PRINT
Exterior and interior lid
40/60/100+ 42¢ each
1000+ 38¢ each
2500+ 31¢ each

SCAN THIS CODE ON
YOUR PHONE TO ORDER



Tuckit® Folding Gift Boxes

- One piece boxes fold and tuck together for a solid bottom
- 18 sizes available • 100% recycled content (min. 35% post consumer) - kraft excluded



Bottom tucks into place
for a secure fit.

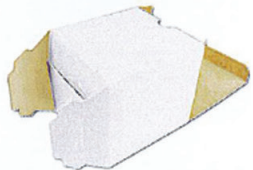

CODE	SIZE (inches)	CASE PACK	ECONO WHITE PRICE/EACH		KRAFT PRICE/EACH		GLOSS COLORS PRICE/EACH	
			100+	1000+	100+	1000+	100+	1000+
334103 __	3 x 3 x 2	100	\$0.40	\$0.36	\$0.35	\$0.32	N/A	N/A
334180 __	3 x 3 x 3	100	\$0.35	\$0.32	\$0.37	\$0.34	N/A	N/A
334111 __	4 x 4 x 4	100	\$0.46	\$0.42	\$0.45	\$0.41	\$0.82	\$0.74
334115 __	6 x 4.5 x 4.5	100	\$0.67	\$0.61	\$0.70	\$0.64	\$1.04	\$0.95
334113 __	6 x 6 x 4	100	\$0.88	\$0.80	\$0.88	\$0.80	\$1.43	\$1.30
334114 __	6 x 6 x 6	100	\$0.96	\$0.87	\$1.13	\$1.03	\$1.37	\$1.24
334120 __	8 x 8 x 3.5	100	\$1.51	\$1.37	\$1.54	\$1.40	\$2.17	\$1.97
33412100	8 x 8 x 6	50	\$2.24	\$1.87	N/A	N/A	N/A	N/A
33412200	8 x 8 x 8.5	100	\$2.72	\$2.26	N/A	N/A	N/A	N/A
334119 __	9 x 4.5 x 4.5	100	\$0.93	\$0.84	\$1.03	\$0.94	\$1.43	\$1.30
334183 __	10 x 5 x 4	100	\$0.96	\$0.88	\$0.87	\$0.79	N/A	N/A
* 334124 __	10 x 10 x 6	50	\$2.67	\$2.43	\$2.88	\$2.62	\$4.89	\$4.48
* 334131 __	12 x 6 x 6	50	\$1.63	\$1.48	\$1.47	\$1.33	\$1.92	\$1.74
* 334125 __	12 x 12 x 2.5	50	\$1.88	\$1.71	\$2.64	\$2.40	\$3.12	\$3.00
* 334136 __	12 x 12 x 5.5	50	\$3.22	\$2.93	\$3.59	\$3.26	\$3.20	\$2.91
334186 __	14 x 6 x 6	50	\$2.37	\$2.15	\$2.75	\$2.50	N/A	N/A
33414500	14 x 14 x 5	25	\$4.09	\$3.71	N/A	N/A	N/A	N/A
33416700	16 x 16 x 7	25	\$5.59	\$5.08	N/A	N/A	N/A	N/A

12P - Kraft Pinstripe



00 - Gloss White



29 - Gloss Red



55 - Gloss Black



SCAN THIS CODE ON
YOUR PHONE TO ORDER



FOIL PRINT

50/100+ 42¢ each
1000+ 38¢ each
2500+ 31¢ each



* not available in Gloss Black

100% recycled content (min. 35% post consumer) – kraft excluded

Please allow 3 - 5 weeks for printed items from approved art.

E-Commerce BOXES AND MAILER ENVELOPES



All print orders subject to set-up charges. Applicable artwork, and plate charges may apply. See page 98.

All print orders subject to set-up charges. Applicable artwork, and plate charges may apply. See page 98.

CREATE YOUR OWN LOOK

Eco-Friendly, Recyclable
E-Commerce Packaging



Custom E-Commerce Gift Boxes

Go above and beyond to impress customers and exceed their expectations by delivering more than just a product, but also an experience.

- Please allow 12 - 14 weeks for printed items from approved art

SIZE (inches)
10 x 6 x 4
11.125 x 8.75 x 4
14.5 x 7.25 x 5
17 x 12 x 4.25
17.125 x 11.125 x 2

NO PLATE CHARGES!

Custom Poly Mailers

- 2.0 mil co-extruded LDPE film
- White exterior with black interior
- 2" adhesive lip
- Plate charges apply
- Please allow 12 - 14 weeks for printed items from approved art

SIZE (inches)	OTHER TYPES OF MAILERS AVAILABLE:	
	Product Description	Minimum Qty
9 x 12 + 2	Recycled Poly Mailers	25,000+
12 x 15 1/2 + 2	Padded Paper Mailers	40,000+
14 1/2 x 19 + 2	Paper Apparel Mailers	10,000+
19 x 24 + 2	Rigid Paper Mailers	10,000+
	Bubble Poly Mailers	25,000+



50% Recycled Shell
Made in the US



Create Your Own Look:
Choose your box style.
Send us your artwork.
For 100% full color
design, speak to your
sales representative.

Ask Your Representative For Details On Personalizing Your E-Commerce Mailers

10,000 minimum
1, 2 or 4 color process. One or both sides

IN STOCK

Available for immediate shipment.

Deliver the 'in-store'
experience to your
customer's door.



Gift and Apparel Ecommerce

- Reversible kraft with oyster or black interior
- Sturdy E Flute for safe delivery in 3 sizes
- Pack flat with 50 pieces/carton

CODE	SIZE (inches)	CASE	OYSTER/KRAFT PRICE/EACH			BLACK/KRAFT PRICE/EACH		
			50+	500+	1000+	50+	500+	1000+
451009 ___	10.25 x 9.062 x 4.375	50	\$2.69	\$2.46	\$2.17	\$3.26	\$2.96	\$2.67
451511 ___	15.562 x 11.062 x 4.562	50	\$3.68	\$3.18	\$2.88	\$3.90	\$3.67	\$3.30
451612 ___	16.937 x 12.625 x 6.5	50	\$4.24	\$3.68	\$3.15	\$4.48	\$3.81	\$3.30

*Kraft and White sides only for Digital Print.
Add a customized In Stock Seal. See page 94.
Add a Special Order Full Color Seal. See page 96.



DIGITAL PRINT
Only on white and kraft.
39¢ each



Jewelry Ecommerce For Geo and Horizon packaging.

- Reversible kraft boxes with black or metallic bronze interior
- Black flock inserts available to fit Horizon and Geo jewelry packaging*
- Minimum case pack 25

CODE	DESCRIPTION	SIZE (inches)	PRICE/EACH		
			25+	250+	1000+
450505 ___	Small Ecom Box	5.75 x 5.75 x 2.5	\$1.62	\$1.52	\$1.28
451010 ___	Large Ecom Box	10.25 x 10.25 x 2.5	\$3.23	\$2.97	\$2.50
Horizon Inserts					
69221003H	Ring to fit small box		\$0.50	\$0.46	\$0.33
69632003H	T-pad to fit small box		\$0.50	\$0.46	\$0.33
69684003H	Utility to fit small box		\$0.50	\$0.46	\$0.33
69693003H	Bracelet to fit large box		\$0.82	\$0.65	\$0.58
Geo Inserts					
69221153G	Ring to fit small box		\$0.50	\$0.46	\$0.38
69283153G	T-pad to fit small box		\$0.50	\$0.46	\$0.38
69293153G	Bracelet to fit large box		\$0.82	\$0.65	\$0.58
69273153G	Necklace to fit large box		\$0.82	\$0.65	\$0.58

Add a customized In Stock Seal. See page 94.
Add a Special Order Full Color Seal. See page 96.

All print orders subject to set-up charges. Applicable artwork, and plate charges may apply. See page 98.

IN STOCK AND SPECIAL ORDER

Bubble Poly Mailers

NO PRINT

- SPECIAL ORDER -			PRICE/EACH	
CODE	SIZE (in)	CASE	1+	4+
52040600	4 x 6.75	500	\$0.46	\$0.44
52060800	6.5 x 8.75	250	\$0.52	\$0.50
52081000	8.5 x 10.75	100	\$0.78	\$0.74

Custom printing available.
Minimum 25,000 quantities.

FOIL PRINT		
200+	42¢ each	
1000+	38¢ each	
2500+	31¢ each	



100% Recycled Shell
Made in the US

Eco-Friendly – “Be Proud of the Way You Ship”

A Recycled Poly Mailers

- IN STOCK -			PRICE/EACH	
CODE	SIZE (in)	CASE	1+	4+
52091286	9 x 12	1000	\$0.42	\$0.40
52101386	10 x 13	1000	\$0.44	\$0.42
52121586	12 x 15.5	500	\$0.58	\$0.55

- SPECIAL ORDER -			PRICE/EACH	
CODE	SIZE (in)	CASE	1+	4+
52060986	6 x 9	1000	\$0.30	\$0.29
52071086	7.5 x 10.5	1000	\$0.35	\$0.33
52141986	14.5 x 19	250	\$0.98	\$0.93
52192486	19 x 24	125	\$1.59	\$1.51
52242486	24 x 24	125	\$2.15	\$2.04

B Padded Paper Mailers

- IN STOCK -			PRICE/EACH	
CODE	SIZE (in)	CASE	1+	4+
52060976	6 x 9	250	\$0.69	\$0.65
52081176	8.5 x 11	100	\$1.08	\$1.02

- SPECIAL ORDER -			PRICE/EACH	
CODE	SIZE (in)	CASE	1+	4+
52101576	10.5 x 15 2	100	\$1.60	\$1.51

C Paper Apparel Mailers

- IN STOCK -			PRICE/EACH	
CODE	SIZE (in)	CASE	1+	4+
52101375	10 x 13	250	\$1.09	\$1.04
52121575	12 x 15.5	150	\$1.46	\$1.39
52101975	10.5 x 4 x 19	100	\$1.74	\$1.64

- SPECIAL ORDER -			PRICE/EACH	
CODE	SIZE (in)	CASE	1+	4+
52070975	7 x 9	250	\$0.74	\$0.70

D Rigid Paper Mailers

- IN STOCK -			PRICE/EACH	
CODE	SIZE (in)	CASE	1+	4+
52061012	6 x 10	500	\$0.54	\$0.51
52061212	6 x 2.5 x 12	500	\$0.77	\$0.73
52091412	9.5 x 14.5	250	\$0.93	\$0.88

- SPECIAL ORDER -			PRICE/EACH	
CODE	SIZE (in)	CASE	1+	4+
52081212	8.5 x 12	250	\$0.71	\$0.67
52101612	10.5 x 16	250	\$1.12	\$1.06
52121912	12.5 x 19	250	\$1.27	\$1.20

For more product information on recyclability and material content, visit gunthermele.com



FINISHING TOUCHES

RIBBON, TISSUE, WRAP AND SEALS



All print orders subject to set-up charges. Applicable artwork, and plate charges may apply. See page 98.

All print orders subject to set-up charges. Applicable artwork, and plate charges may apply. See page 98.

GIFT WRAP

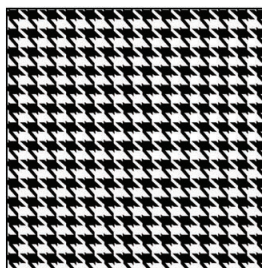
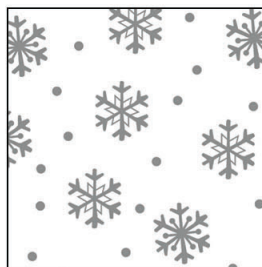
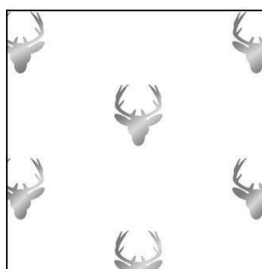
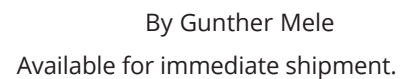

EVERYDAY

SCAN THIS CODE ON
YOUR PHONE TO ORDER

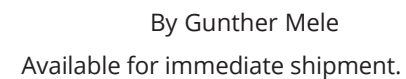
A square QR code with a black and white pixelated pattern, used for mobile scanning to access product information or place an order.

SCAN THIS CODE ON
YOUR PHONE TO ORDER

HOLIDAY

A square QR code with a black and white pixelated pattern, used for linking to the holiday collection.

8" x 150' – Jewelers Rolls 
\$54.91 Code # 57 ____ 07
 each

Sullivan Designs

Please allow 4 - 6 weeks for shipment.

Sullivan Designs

GIFT WRAP

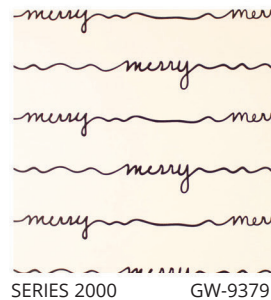
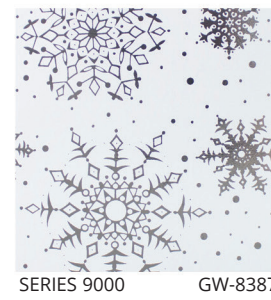

SULLIVAN designs available in 1/2 Ream Rolls and Full Ream Rolls

SLITTING CHARGE: A slitting charge of \$25.00 applies to each individual roll. No more than two slits per roll; (2 slits = \$25.00)

**View our entire
Selection online at
GUNTHERMELE.COM**

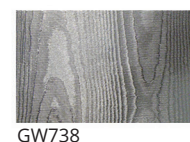

Jewelers Rolls

Size: 7.375" x 150'

\$84.79/roll

Minimum order 1 roll.
JRX150 - Jeweler Roll suffix code.



Gift wrap dispenser with serrated edge can be added to your custom jewelers roll order for \$6.11 each.
Code: 09715000

CREATE YOUR OWN LOOK

• Please allow 6 - 8 weeks for printed items from approved art.



Printed Tissue: Pick a PMS print color and we will match it.
– See page 87 for Special Order Tissue Colors!

CODE	DESCRIPTION	SIZE (in)	PACKAGED	PRICE/EACH	
				10 REAMS	30 REAMS
20869000G	White	20 X 30	480	\$100.24	\$86.73
20869000M	Colored	20 x 30	480	\$128.02	\$110.76
20869000GK	Kraft	20 x 30	480	\$130.09	\$112.55
20869001M	Metallic SS*	20 x 30	200	\$253.94	\$240.81

* SS - single sided

Print included in price of tissue.

Minimum 10 reams. Note: Plates extra \$225.00 (per color).
Ships in approximately 6 - 8 weeks.

For metallic ink print: add 10% to the price above.
For > 50% ink coverage, an additional \$10 per ream.
All custom orders subject to a +/-10% over/under run.

Custom Printed
White Tissue – 10 Reams
\$1,002.40

IN STOCK

Available for immediate shipment.

Spotlight Tissue Colors

10 in stock tissue colors to choose from.
Plus check out our assorted Pre-Pack!



CODE	DESCRIPTION	SIZE (in)	PKG	PRICE/EACH		
				1 - 4 REAMS	5+ REAMS	25+ REAMS
20819290S	White Economy	19 x 29	480	\$25.65	\$23.50	\$21.36
208551__G	Spotlight on Value (colors)	20 x 30	480	\$34.97	\$31.99	\$28.86
208559__G	Spotlight on Value (metallic)	20 x 30	200	\$81.60	\$77.99	\$75.59
20850102	#1 White Economy	19 x 14.5	480	\$13.06	\$11.97	\$10.88
20851800	#1 White Bleached	18 x 9 dia.	1 roll	\$130.53/roll		
20852000	#1 White Bleached	20 x 9 dia.	1 roll	\$139.86/roll		

16 ORANGE	19 BRIGHT LIME	56 ZIPPY GRAPE	60 EMERALD	07 GOLD	08 SILVER
14 DANDELION	21 HOT PINK	66 BURGUNDY	* Dandelion (14), Hot Pink (21) and Burgundy (66): 1-4 REAMS \$55.08/ea 5+ REAMS \$52.07/ea 25+ REAMS \$50.39/ea		

SPECIAL ORDER

Unprinted Tissue

*Unprinted, minimum 1 ream (per color).
Ships in approximately 4 - 6 weeks.*

											PRICE/REAM		
		CODE		DESCRIPTION		SIZE (in)		Packaged		1 REAM		25+ REAMS	
Unprinted, minimum 1 ream (per color). Ships in approximately 4 - 6 weeks.		20899__		Special Order Colors		20 x 30		480 sheets		\$48.85		\$43.97	
NE-350 FRENCH VANILLA		NE-210 LIGHTYELLOW		NE-220 YELLOW		NE-222 DANDELION		NE-230 GOLDENROD		NE-357 NOBLE GOLD		NE-195 TANGERINE	
		NE-366 BURNT SIENNA		NE-190 PEACH		NE-200 ORANGE		NE-226 POPPY					
NE-100 LIGHT PINK		NE-110 PINK		NE-145 FUCHSIA		NE-124 AZALEA		NE-120 CORAL ROSE		NE-148 HOT PINK		NE-150 CERISE	
		NE-345 CRANBERRY		NE-126 SCARLET		NE-131 DEEP SCARLET		NE-130 RED					
NE-325 LILAC		NE-330 LAVENDER		NE-335 PERIWINKLE		NE-155 ZIPPY GRAPE		NE-160 PURPLE		NE-340 PLUM		NE-165 BURGUNDY	
		NE-281 BLUE BREEZE		NE-235 PISTACHIO		NE-375 ANTIQUE BLUE		NE-305 CERULEAN					
NE-278 AZURE		NE-279 OXFORD BLUE		NE-300 TURQUOISE		NE-306 BRILLIANT BLUE		NE-308 SAPPHIRE		NE-310 DARK BLUE		NE-385 NAVY BLUE	
		NE-382 COLONIAL BLUE		NE-318 TROPICAL BLUE		NE-265 TEAL		NE-270 DARK GREEN					
NE-274 CEDAR GREEN		NE-250 MID GREEN		NE-251 GROOVY GREEN		NE-241 KEY LIME		NE-247 JADE		NE-255 BRIGHT LIME		NE-269 OASIS GREEN	
		NE-277 TAPESTRY GREEN		NE-273 FESTIVE GREEN		NE-246 EMERALD		NE-275 FOREST GREEN					
NE-361 BERMUDA SAND		NE-362 TERRA COTTA		NE-171 MOCHA		NE-360 DESERT TAN		NE-164 SANDSTONE		NE-276 DRIED SAWGRASS		NE-347 CRÈME	
		NE-417 PARCHMENT		NE-223 OATMEAL		NE-370 CHOCOLATE		NE-359 ESPRESSO					
NE-371 RAW SIENNA		NE-356 GRANITE		NE-389 MOUNTAIN MIST		NE-386 MORNING MIST		NE-390 GRAY		NE-391 CRACKED PEPEPR		NE-400 BLACK	
		NE-410 BIRCH		NE-415 DUNE BEIGE									

IN STOCK

Available for immediate shipment.

Curling Ribbon

See chart for available colors

CODE	PRICE/ROLL
COLORS - 3/16" x 500 yards 148373 __	\$3.98
METALLIC - 3/16" x 250 yards 148378 __	\$10.79



2.75" Star Bows

See chart for available colors

CODE	CASE PACK	PRICE/EACH	
		200+	1000+
COLORS - 2.75" x 17 loop 142311 __	200	\$0.14	\$0.12
METALLIC - 2.5" x 17 loop 14531107 Gold	200	\$0.12	\$0.11
14531108 Silver	200	\$0.12	\$0.11
Min: case pack			



3.75" Star Bows

See chart for available colors

CODE	CASE PACK	PRICE/EACH	
		100+	1000+
COLORS - 3.75" x 13 loop 143512 __	200	\$0.16	\$0.18
METALLIC - 3.75" x 17 loop 14551207 Gold	200	\$0.21	\$0.18
14551208 Silver	200	\$0.21	\$0.18
Min: case pack			

Splendor Ribbon

See chart for available colors

CODE	PRICE/ROLL
COLORS - 3/4" x 250 yards 141050 __	\$12.91
METALLIC - 3/4" x 100 yards 14013007 Gold	\$17.60
14013008 Silver	\$17.60



99 - Everyday Assortment Star Bows
Available in 2.75" and 3.75"



98 - Christmas Assortment Star Bows
Available in 2.75" and 3.75"



Metallic Star Bows
Available in 2.75" and 3.75"



RIBBONS

BOWS

Color # Name	Curling Ribbon	2.75" Star Bows	3.75" Star Bows	Splendor Ribbon
00 - White				
86 - Ivory				
29 - Vanilla				
61 - Pastel Yellow				
03 - Yellow				
13 - Daffodil				
14 - Sunshine Yellow				
07 - Gold				
08 - Silver				
27 - Holiday Gold				
22 - Melon				
16 - Tropical Orange				
17 - Orange				
12 - Chocolate				
75 - Baby Pink				
01 - Pink				
57 - Azalea				
09 - Hot Red				
62 - Marsala				
41 - Beauty				
59 - Dubonnet Rose				
28 - Orchid				
05 - Lavender				
56 - Purple				
54 - Periwinkle				

Color # Name	Curling Ribbon	2.75" Star Bows	3.75" Star Bows	Splendor Ribbon
50 - Plum				
11 - Royal				
81 - Navy				
77 - Baby Blue				
02 - Light Blue				
47 - Aqua				
32 - Caribbean Blue				
55 - Robin's Egg				
25 - Turquoise				
71 - Sea Green				
18 - Celery				
60 - Hunter				
84 - Teal				
04 - Mint				
19 - Citrus				
96 - Leaf				
30 - Celadon				
10 - Emerald				
15 - Black				
07 - Metallic Gold				
08 - Metallic Silver				
99 - Everyday Assortment	N/A			N/A
98 - Christmas Assortment	N/A			N/A

IN STOCK

Available for immediate shipment.

Perfect Bows™

Minimum: 50 per size, per color.
More colors and sizes available. See our website.

CODE	SIZE	PRICE/EACH	
		50+	1000+
140515 __	5.5" Perfect Bow	\$1.43	\$1.29



Pull Bows

CODE	SIZE	PRICE/EACH			
		STANDARD COLORS 100+	COLORS 1000+	METALLIC COLORS 100+	COLORS 1000+
132000 __	Petite 2" Bows	\$0.26	\$0.22	\$0.35	\$0.33
134000 __	Std. 4" Bows	\$0.47	\$0.43	\$0.63	\$0.59



Matte Wraphia™

CODE	SIZE	PRICE/ROLL
148367 __	100 yds	\$11.16

Paper Roll/Ream Dispenser and Tape

CODE	DESCRIPTION	PRICE/EA
09850124	Paper Roll/Ream Roll dispenser - 24" rack	\$74.57



Cellophane (1.0mil)

CODE	DESCRIPTION	SIZE	PRICE/ROLL
16400506	Clear Cellophane	40" x 100'	\$18.54



Mini Metallic Star Bows

252 per pack

CODE	DESCRIPTION	PRICE/PACK
14121099	Assorted	\$39.17
14121017	Gold	\$39.17
14121008	Silver	\$39.17

Ribbon Shredder

CODE: 09878600
PRICE: \$7.78 each

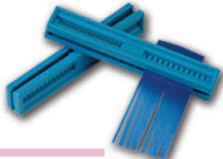

Curling Ribbon Roll Dispenser

CODE: 09850100
PRICE: \$134.00 each



Holds 12 Rolls

SPECIAL ORDER

Unprinted Satin and Grosgrain Ribbon

See chart to the right for ribbon colors.

Single Face Satin

WIDTH	CODE	PRICE/EA
3/8" x 100 yd roll	14031 _ _ _	\$21.23
5/8" x 100 yd roll	14032 _ _ _	\$24.59
7/8" x 100 yd roll	14033 _ _ _	\$42.72
1-1/2" x 50 yd roll	14034 _ _ _	\$28.21

1 roll minimum. Lead time please allow 4 -6 weeks for shipment. SPECIAL ORDER

Grosgrain

WIDTH	CODE	PRICE/EA
3/8" x 100 yd roll	14160 _ _ _	\$20.30
5/8" x 100 yd roll	14161 _ _ _	\$25.93
7/8" x 100 yd roll	14162 _ _ _	\$40.00
1-1/2" x 50 yd roll	14170 _ _ _	\$24.73



Printed Satin Ribbon

Enquire about our new selection of ribbon colors from your sales representative.

Single Face Satin

WIDTH	CODE	PRICE/EA
3/8" x 100 yd roll	14150002	\$41.22
5/8" x 100 yd roll	14150003	\$44.10
7/8" x 100 yd roll	14150005	\$51.32
1-1/2" x 100 yd roll	14150015	\$82.44

(2 x 50 yd rolls)
500 yard minimum per width. Note: Plates extra \$94.00 (per color).

Foil Print Colors

Red	Blue	Green	Black	Brown	Burgundy
Navy	Yellow	White	Gold	Silver	Copper



FOIL PRINT
Included in price of ribbon
Please allow 3 -4 weeks for printed items from approved art.



Contact your sales representative.

SPECIAL ORDER

While we strive for accuracy in our catalog, actual product may be slightly different than pictured. Please allow 3 -4 weeks for printed items from approved art.

3/8"		5/8"		7/8"		1-1/2"		COLOR NUMBER AND NAME
Single Face Satin	Grosgrain	Single Face Satin	Grosgrain	Single Face Satin	Grosgrain	Single Face Satin	Grosgrain	
								029 - White
								007 - Shell Grey
								012 - Silver
								015 - Grey
								022 - Pewter
								028 - Antique White
								813 - Oyster
								016- Portobello
								030 - Black
								115 - Powder Pink
								117 - Light Pink
								150 - Pink
								156 - Hot Pink
								175 - Shocking Pink
								187 - Azalea
								241 - Living Coral
								250 - Red
								252 - Hot Red
								260 - Scarlet
								275 - Wine
								277 - Burgundy
								285 - Plum
								305 - Light Blue
								331 - Dusty Blue
								312 - Blue
								315 - Navajo Turquoise
								329 - Cobalt
								340 - Turquoise
								343 - Tornado Blue
								350 - Royal
								352 - Electric Blue
								353 - Century Blue
								365 - Light Navy
								370 - Navy
								412 - Purple Haze
								430 - Light Orchid
								450 - Orchid

3/8"		5/8"		7/8"		1-1/2"		COLOR NUMBER AND NAME
Single Face Satin	Grosgrain	Single Face Satin	Grosgrain	Single Face Satin	Grosgrain	Single Face Satin	Grosgrain	
								462 - Royal Orchid
								464 - Delphinium
								465 - Purple
								470 - Regal Purple
								473 - Amethyst
								528 - Lemon Grass
								530 - Mint
								533 - Jungle Green
								547 - New Chartreuse
								548 - Kiwi
								550 - Apple Green
								558 - Leaf
								567 - Spring Moss
								570 - Moss
								580 - Emerald
								586 - New Neon Green
								587 - Forest Green
								617 - Baby Maize
								640 - Lemon
								645 - Daffodil
								650 - Maize
								660 - Yellow Gold
								675 - Gold
								690 - Old Gold
								722 - Burnt Sienna
								743 - Ginger
								750 - Torrid Orange
								789 - Sherry
								790 - Currant
								810 - Ivory
								815 - Cream
								825 - Natural
								835 - Tan
								841 - Khaki
								850 - Brown
								866 - Coffee

IN STOCK

In stock and ready to ship.

Simply Sheer Asiana Ribbon



Monofilament-Edge

CODE	SIZE	PRICE/ROLL
149435 __	7/8" x 100 yards	\$17.77
149436 __	1 1/2" x 100 yards	\$17.77

• minimum order: one roll.

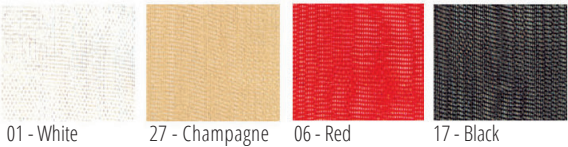

Can be special ordered in additional colors!



SCAN THIS CODE ON
YOUR PHONE TO ORDER

CREATE YOUR OWN LOOK

Please allow 4 - 6 weeks
for printed items from
approved art.

Raised Ink Printing See chart below for ribbon colors.

Pick your own colors for raised print - NO PLATE CHARGE

Available in: 5/8" x 100 yd roll, 7/8" x 100 yd roll, 1-1/2" x 50 yd roll
40 roll minimum for all printed ribbon.

SPECIAL ORDER

Please allow 4 - 6 weeks for shipment.

Contessa Ribbon



Wire-Edge
Single Face Satin

CODE	SIZE	PRICE/ROLL
14163 __	1 1/2" x 25 yards	\$17.35
*14164 __	2 1/4" x 25 yards	\$26.02

• minimum order: one roll.



* 2-1/4" is only available in 029-White, 260-Scarlet and 810-Ivory.



SCAN THIS CODE ON
YOUR PHONE TO ORDER

Encore Ribbon



Wire-Edge

CODE	SIZE	PRICE/ROLL
141650 __	5/8" x 25 yards	\$9.68
141660 __	1 1/2" x 25 yards	\$19.36
141670 __	2 1/2" x 25 yards	\$25.91

• minimum order: one roll.



* not available in 5/8"
† not available in 2 1/2"



SCAN THIS CODE ON
YOUR PHONE TO ORDER

Sheer Ribbon Colors

All colors are available in all sizes. See page 90-91 for single face satin and grosgrain color availability.



Single Face Satin Ribbon with Raised Print



Sheer Ribbon with Raised Print



Grosgrain Ribbon with Raised Print

IN STOCK



SCAN THIS CODE ON YOUR PHONE TO ORDER

Customized Seals-Foil Printed

CODE	SIZE	One color foil print/each		SPECIAL ORDER Two color/each		SPECIAL ORDER Acetate 1 color/each		SPECIAL ORDER Acetate 2 color/each	
		2000+	5000+	2000+	5000+	2000+	5000+	2000+	5000+
25 4 digit label code 2 digit label color	A	\$0.0880	\$0.0820	\$0.1512	\$0.1188	\$0.1728	\$0.1350	\$0.1976	\$0.1533
	B	\$0.1000	\$0.0900	\$0.1620	\$0.1296	\$0.2074	\$0.1630	\$0.2376	\$0.1900
	C	\$0.1200	\$0.1100	\$0.1782	\$0.1447	\$0.2473	\$0.1901	\$0.2786	\$0.2268
	D*	\$0.1350	\$0.1200	\$0.1858	\$0.1544	\$0.3056	\$0.2451	\$0.3348	\$0.2635
		\$80 plate charge		NO PLATE CHARGES					

Label Colors Available:

06
Clear

00
White

17
Met. Gold

18
Met. Silver

15
Black

07
Mat Gold

08
Mat Silver

10
Dark Green

* D sized Seals and Clear print are SPECIAL ORDER.
See foil chart on inside back cover of catalog for available print colors.



FOIL PRINT
Included in the price.
Please allow 2-3 weeks for printing.

Pre-printed Labels

Available for immediate shipment.

10K GOLD

25401007S

10K GOLD

25401007V

STERLING SILVER

25406208S

14K GOLD

25401407S

14K GOLD

25401407V

STERLING SILVER

25406008V

CODE	SIZE	CASE	PRICE/EACH	
			1000+	5000+
25401007S	5/8 x 3/8"	1000	\$0.092	\$0.086
25401407S	5/8 x 3/8"	1000	\$0.092	\$0.086
25406208S	5/8 x 3/8"	1000	\$0.092	\$0.086
25401007V	3/4" oval	1000	\$0.092	\$0.086
25401407V	3/4" oval	1000	\$0.092	\$0.086
25406008V	3/4" oval	1000	\$0.092	\$0.086

1000/box minimum order - 1 box of 1000.



SCAN THIS CODE ON YOUR PHONE TO ORDER

Embossed Seals

Available for immediate shipment.

500/box min. order - 1 box.	CODE	SIZE	PRICE/EA
	Gold 08701207	1.5" dia.	\$0.04
	Silver 08701208	1.5" dia.	\$0.04

ACTUAL EMBOSSED PATTERN 1.5" DIA.

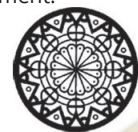

SCAN THIS CODE ON YOUR PHONE TO ORDER

For a no-print solution, order our in stock embossed seals.

IN STOCK

1-3/4" wide B7040

1-1/4" wide A7003 B7002 B7001 2-3/4" wide C7000

2-1/4" wide C7051

2-5/8" wide C7070

1-3/4" wide B7021 2-3/4" wide B7020

2-1/4" wide B7035

3" wide D7013 1-1/2" wide B7012 2" wide C7015 3-3/4" wide D7033 2-1/4" wide C7029 2-3/4" wide D7034

1-1/4" wide A7032 1-1/2" wide B7031 2" wide B7030

1-1/2" wide B7014

1" wide 1-1/2" wide C7090 5/8" wide A4062 3/4" wide A4061 3/4" wide A4060

1-3/4" wide B7050

All print orders subject to set-up charges. Applicable artwork, and plate charges may apply. See page 98.

SPECIAL ORDER

Custom Full Color Seals

CUSTOM FULL COLOR SEALS

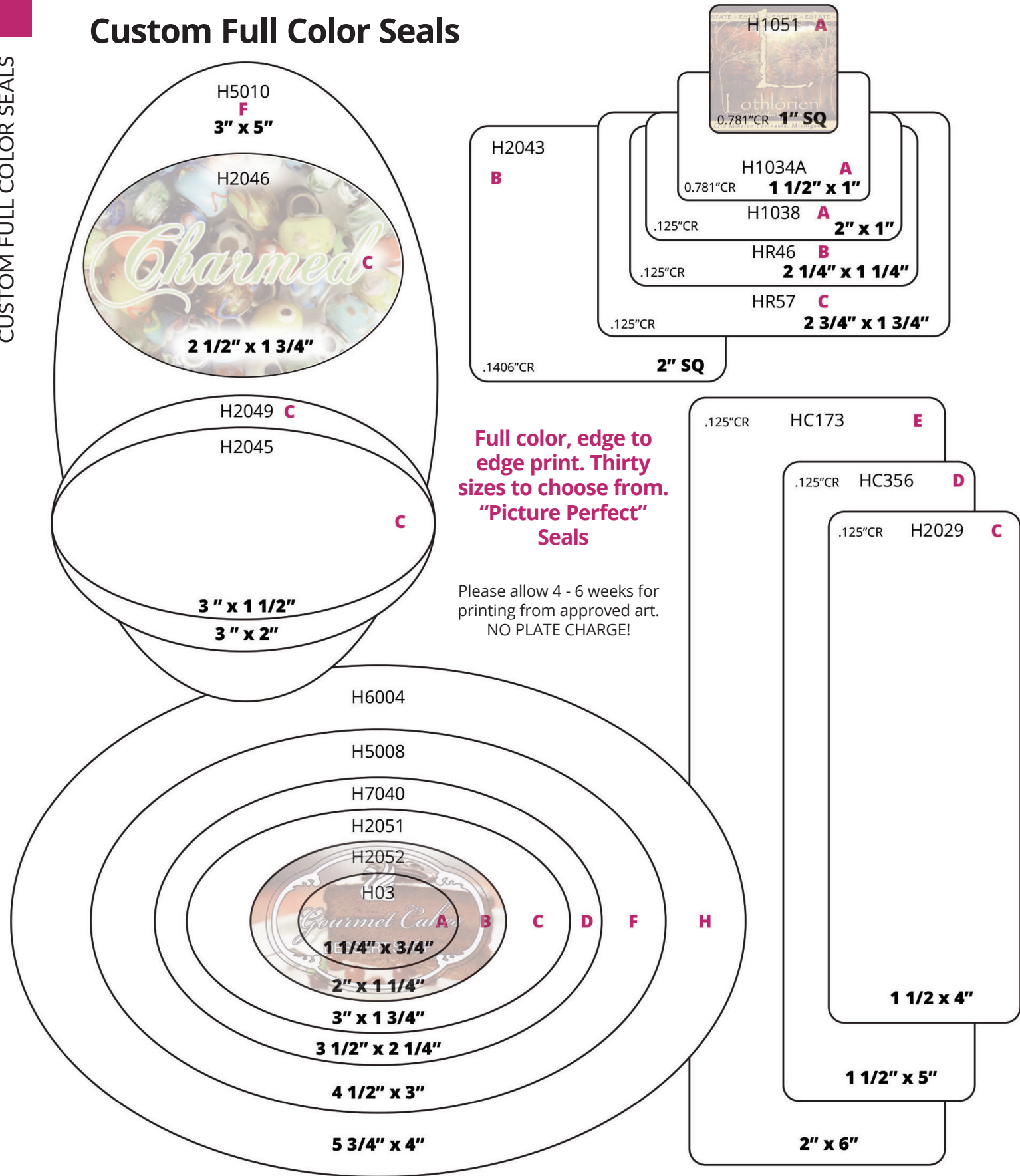

SPECIAL ORDER

Custom Full Color Seals

CUSTOM FULL COLOR SEALS

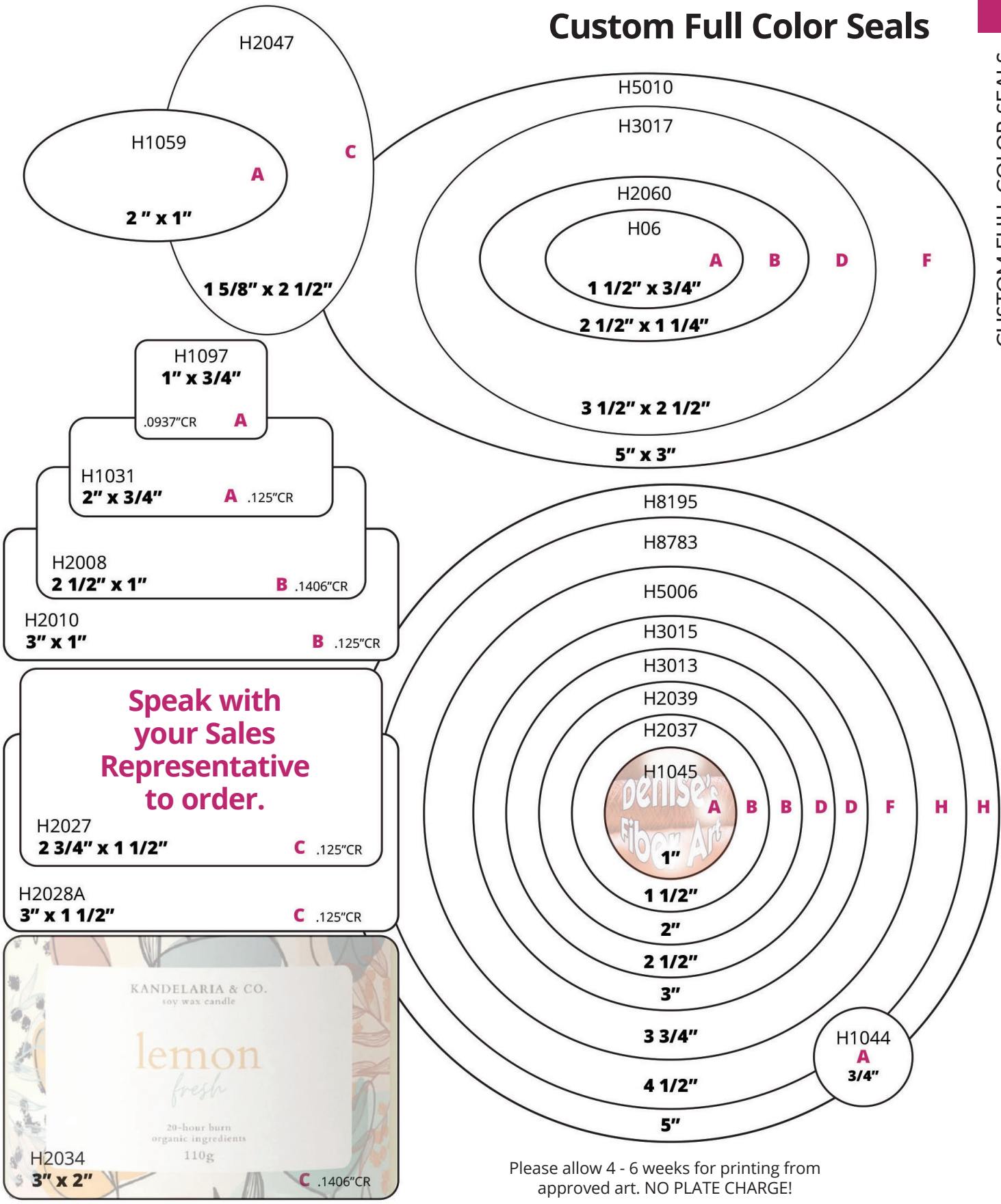

PRINTING INFORMATION

Have your name and logo printed... it's easy!



1. **Select your box or bag style, color and size.**
2. **Choose the printing method you wish to use.**

- A. **FOIL PRINTING:** Foil is applied to the bag or box using a combination of heat and pressure on a magnesium print plate to create an elegant appearance. Choice of Metallic or Matte foils. Foil Printing Print plate per size and color - \$77.00 (max. 30 square inches)
- B. **PAD PRINTING:** Ink is applied to smooth surfaces allowing us to print your logo in places never before possible. Cost of Pad Print plate per size and color - \$104.50 (maximum 3.75 square inches)
- C. **FULL COLOR DIGITAL PRINT:** Utilizing the latest 4-color process technology, we now offer full color digital printing graphics on non-laminated paper bags and boxes.
- D. **FULL COLOR TRANSFER:** We offer full color transfer printed graphics on fabric and nylon bags using a heat press process. This full color transfer print creates an image that allows for vibrant designs. Pricing is the same regardless of the amount of colors used in a design. Have your full color image applied to your bags for just \$2.45 per bag (minimum 300 bags)
- E. **INK PRINTING:** Ink is applied to the box or bag using a rubber printing plate. This method is ideal for larger coverage prints and is economically priced. Cost of Ink Printing Plate per size per color starting at \$137.50. (maximum 25 square inches)
- F. **SILK SCREEN:** Die fast ink is applied to Fabric Style Bags through a screen. The process allows the ink to permeate into the fabric dimples for optimal coverage. Screen charge of \$65.00 applies with each order.

3. Choose the Print Color

When Foil Printing, select from 41 foil colors in 4 different finishes: Metallic (High Sheen or Matte), flat, gloss or pearized. For ink printing select from our 9 standard colors for in stock items, or ask about Pantone Matching for Special Order items such as Simply Bags and Fabric Style Bags.

4. Send us your artwork.

If you are a new print customer, send us your artwork by e-mail. Artwork must be vector with fonts outlined or high resolution (300 dpi) actual size jpg if vector can not be located.

If you don't have artwork or your artwork needs adjustments, we have a talented design team who can assist you. Contact one of our sales representatives or email us your ideas today. For pricing, see the artwork charges section.

Acceptable Artwork Formats

- Vector files (preferred): Adobe Illustrator with .ai, .eps, or .pdf file extension. If the logo was ever professionally made, at a marketing agency, print shop or sign maker, they will have the logo on file. Check with the original graphic designer. If vector cannot be provided, ALL raster formats will be subject to additional art charges as in most cases it will have to be converted to a vector to meet our printers requirements.
- Raster files: (ie. PDF, PSD,TIF, or JPEG) Actual size, high resolution (300dpi or more), is required for all full color reproduction.
- Please include fonts (.ttf) or convert fonts to outlines when sending ANY Illustrator file, saved as AI, EPS or PDF.

The following formats are NOT acceptable

- Publisher (.pub) • CorelDraw (.cdr) • small GIF or BMP internet images • low resolution JPG
- Any Word or spreadsheet documents - '.docx', '.xls', '.wpd', '.od

If unsure about any format including "what is a vector" please send all inquiries to your inside Customer Service Rep.

OTHER PRINTING COSTS

Artwork Charges: As mentioned above, we have a talented creative team that can work with you to design, create, manipulate or re-size your store logo or name. Artwork service is charged at a rate of \$85.00/hour, min. 1/2 hour.

Set-up Charges: Every print job requires a machine to be set-up. A charge will be applied to every order. Foil, Ink, Pad and Digital printing is charged at \$39.00. Silk Screen printing is \$75. Please note: multiple print sizes of the same logo require multiple set-ups.

Plate Charges: Plate charges apply one-time only. Each time you require a 'new' print design (i.e. Logo change, Print Size Adjustment etc.) a new plate must be created. Once the plate is made, we will hold it for you in our warehouse and it will be available for all future printing requirements. Plate charges range in cost from \$80.00 for a Foil Printing plate to \$137.50+ for an Ink Printing Plate. (maximum 25 square inches)

FOIL STAMPING COLORS

Metallic Options

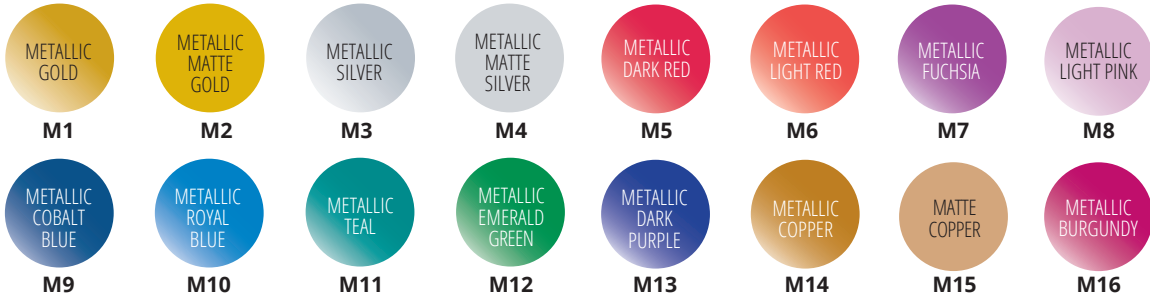

Metallic options feature a high sheen finish unless otherwise indicated as matte finish.

Flat Options



Pearlized Options

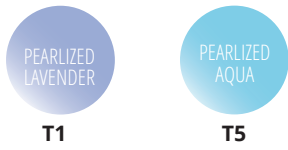

Gloss Options

Gloss Clear - allows the color of the bag or box to show-through. Gives that tone on tone special highlighted look.



Satine Foil Colors



INK PRINTING COLORS



PAD PRINTING COLORS

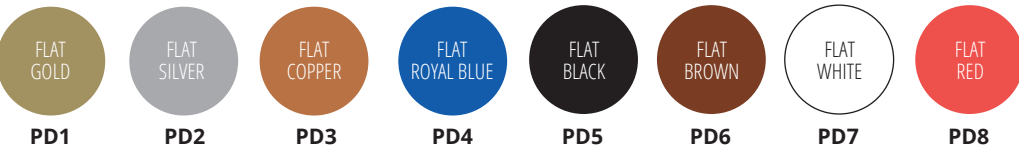

Colors shown are representations only and may not reflect true production colors.

Want it. Design it. Get it.

PLACE AN ORDER

Toll Free CANADA: 1.888.486.8437
Email: packaging@gunthermele.com

Toll Free USA: 1.800.516.0108
Email: gmp@gunthermele.com

Order on line: gunthermele.com



EASY PAYMENT OPTIONS

- Online at: gunthermele.com and pay with your credit card
- Over the phone, by: Visa or Mastercard
- Via your bank's online bill payment option by selecting "Gunther Mele" as payee
- Contact head office to set up EFT or ACH

Sign up for paperless billing. See our website for more information.

TERMS AND CONDITIONS:

- Minimum order \$250.00.
- F.O.B point CANADA: Brantford, Ontario Canada
- F.O.B. point USA: Buffalo, NY USA.
- Net 30 days O.A.C.
- New account payment terms: Visa or MasterCard 50% deposit with order, balance due upon shipping.
- Defective merchandise will be accepted back for credit only if claimed within 15 days of receipt of shipment. Authorization number must be obtained by contacting our customer service department 1.888.486.8437.
- In-transit damages and shortages must be claimed with the freight carrier at time of delivery.
- All lead times are estimates only (from receipt of approved artwork and credit) and are not guaranteed.
- Plate charges where applicable are:
 - Foil Print Dies: \$80.00 per size (maximum 30 square inches)
 - Pad Dies: \$104.50 per size (maximum 3.75 square inches)
 - Ink Plates \$137.50 (maximum 25 square inches)
- **While we strive for accuracy in our catalogue, actual product may be slightly different than pictured.**
- Prices subject to change without notice.



GUNTHERMELE.com



@gunthermele



signature.gunthermele.com